

## Dual Switch Bollard Post - CBC compliant

Distributor Discount Code **CK**



**NEW**

- California CBC Section 11B 404.3 code compliant bollard and switch plates
- Black HDPE mortised removable cap with secure transmitter mount
- Two 4-1/2" Push to Open blue infill push plates, located at 7" and 36" centerline from floor
- 6" square post with 1/8" walls
- Surface mount (42")

### SPECIFY MODEL

LIST

Model	Description	
<b>CBC482A4U</b>	42" surface mount, 6" square post, with high and low 4-1/2" SPDT switch plates	<b>667.00</b>
<b>CBC484A4U</b>	42" surface mount, 6" square post, with high and low 4-1/2" DPDT switch plates	<b>717.00</b>

## Bollard Post

Distributor Discount Code **CK**



Push Plate and Touch Panel NOT INCLUDED see page 78 for ordering info

- For use with Push Plates, Touch Panel Columns & Exit Switches
- Black HDPE mortised removable cap with secure transmitter mount
- Standard single gang prep located at 36" from finished floor
- 6" square with 1/8" walls
- Surface mount (42") or In-Ground mount (54")

### SPECIFY MODEL

LIST

Model	Description	
<b>BPS6</b>	42" surface mount, 6" square post	<b>404.00</b>
<b>BPG6</b>	54" in-ground, 6" square post	<b>404.00</b>

### SPECIFY PREP

Add to List

<b>S</b>	1-gang prep	<b>N/C</b>
<b>D</b>	2-gang prep	<b>N/C</b>
<b>P</b>	Touch Panel prep	<b>N/C</b>
<b>A</b>	Narrow Mullion Prep	<b>N/C</b>

### SPECIFY FINISH

Add to List

<b>V</b>	628 Aluminum (standard)	<b>X</b>	710 Dark Anodized Aluminum	<b>N/C</b>
----------	-------------------------	----------	----------------------------	------------

## 400 Series Wireless Transmitter and Receiver

Distributor Discount Code **CK LIST**

### For Remote Control Versatility for Touch Panel Column and Push Plate Switches



#### 433MHz Micro Transmitter

- Requires a non-metallic surface box or standard bollard cap (non-metallic). Works with 400RC433
- Pre-Wired for quick installation
- Antenna magnifies signal

**Voltage Input:** 9V Battery (included)  
**Trigger Input:** Momentary, N.O.Dry Contact  
**Temperature:** -20F — 100F  
**Dimensions:** 1-9/64" x 15/16" x 7/32" (29 x 49 x 6mm)

Model	Description	
<b>400W1-433</b>	433MHz Micro Transmitter	<b>75.00</b>



#### 433MHz 1 Channel Nano Receiver

- Designed to control automatic closing and anti-burglar systems. Works with 400W1-433.

**Carrier Frequency:** 433.92 MHz  
**Relay Numbers:** 1  
**Temperature:** -4F — 158F  
**Power Supply:** 12/24 VAC/DC  
**Contacts:** C-NO  
**Dimensions:** 1-1/4" x 2" x 3/4" Deep (32 x 51 x 19mm)

Model	Description	
<b>400RC433</b>	433MHz 1 Channel Receiver	<b>88.00</b>



**SECURITY DOOR CONTROLS**  
 801 Avenida Acaso • Camarillo, CA 93012  
 Email: Service@sdgsecurity.com • www.sdgsecurity.com

Price List Effective February 1, 2017

**For Handicap Access, Automatic Door Activation & Request-to-Exit Applications**

- Door Opener Activation
- Automatic Door Activation
- Access Control Request-to-Exit (RTE)
- Door Sequencer Activation



= can be used with wireless transmitter and receiver

**SPECIFICATIONS**

<b>Mounting Plate</b>	Heavy Duty 1/8" (3.2mm) mounting plate
<b>Faceplate</b>	Heavy 18 Gauge (1.02mm), 630/US32D Satin Stainless Steel Standard
<b>Legends</b>	Bold debossing or engraving with black, blue or white infill
<b>Contacts</b>	SPDT or DPDT, 15 Amps @ 125/250VAC; UL 1054, CSA Listed
<b>Depth</b>	[Narrow & (1) Gang] SPDT-7/8" deep, DPDT-1-3/8" deep, [4 1/2", & 6" square/ round] SPDT-3/4" deep, DPDT-1-5/32"



**1-11/16" Narrow Mullion Push Plate Switch – Recessed, Surface Box or Bollard Mount**

SPDT Model	Description	DPDT Model	Description
<b>48201U</b>	Push to Open, black infill	<b>65.00</b>	<b>48401U</b> Push to Open, black infill <b>90.00</b>
<b>482A1U</b>	Push to Open, blue infill	<b>65.00</b>	<b>484A1U</b> Push to Open, blue infill <b>90.00</b>
<b>400-1B</b>	Narrow Mullion Surface Box, 1-3/4" x 4-9/16" x 1-3/4" O.D.		<b>19.00</b>



**2 3/4" x 4 1/2" Single (1) Gang Push Plate Switch**

- Pressing any part of the push plate (2 3/4" x 4 1/2") causes switch actuation
- Recessed, Surface Box or Bollard Mount
- Depth: SPDT - 3/4" deep; DPDT - 1 1/2" deep

SPDT Model	Description	DPDT Model	Description
<b>48202U</b>	Push to Open, black infill	<b>77.00</b>	<b>48402U</b> Push to Open, black infill <b>102.00</b>
<b>482A2U</b>	Push to Open, blue infill	<b>77.00</b>	<b>484A2U</b> Push to Open, blue infill <b>102.00</b>
<b>480-2SB</b>	Surface mount box, 2 3/4" x 4 1/2" x 1 5/8" O.D.		<b>29.00</b>



**4 1/2" x 4 1/2" Square Push Plate Switches**

- Pressing any part of the push plates 4 1/2" x 4 1/2" active area causes switch actuation
- 1 Gang or 2 gang recessed or Surface Box Mount
- Depth: SPDT 5/8" deep; DPDT 1 1/2" deep

SPDT Model	Description	DPDT Model	Description
<b>48204U</b>	Push to Open, black infill	<b>85.00</b>	<b>48404U</b> Push to Open, black infill <b>110.00</b>
<b>482A4U</b>	Push to Open, blue infill	<b>85.00</b>	<b>484A4U</b> Push to Open, blue infill <b>110.00</b>
<b>480-4FB</b>	Square Flush Recessed box, 1-gang, 6 3/4" x 6 3/4" x 1 7/8" O.D.		<b>63.00</b>
<b>480-4SBB</b>	Surface mount box, 4-1/2" x 4-1/2" x 1 3/4" O.D. with Battery compartment for wireless		<b>33.00</b>
<b>480-4SB</b>	Surface mount box, 4-1/2" x 4-1/2" x 1 7/8" O.D.		<b>63.00</b>
<b>480-4SE</b>	3-sided stainless shroud for exterior applications, 4-11/16" x 4-7/8" x 12"		<b>38.00</b>

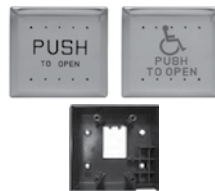

**6" x 6" Square Push Plate Switch**

- Pressing any part of the push plates 6" x 6" active area causes switch actuation
- 1 Gang or 2 gang recessed or Surface Box Mount
- Depth: SPDT 5/8" deep; DPDT 1 1/2" deep

SPDT Model	Description	DPDT Model	Description
<b>48206U</b>	Push to Open, black infill	<b>90.00</b>	<b>48406U</b> Push to Open, black infill <b>114.00</b>
<b>482A6U</b>	Push to Open, blue infill	<b>90.00</b>	<b>484A6U</b> Push to Open, blue infill <b>114.00</b>
<b>480-6SBB</b>	Surface mount box, 2-gang Battery Compartment, 4 1/2" x 4 1/2" x 1 3/4" O.D.		<b>33.00</b>

Price List Effective February 1, 2017

**SDC SECURITY DOOR CONTROLS**  
 801 Avenida Acaso • Camarillo, CA 93012  
 Email: Service@sdsecurity.com • www.sdsecurity.com



## 480 Series Push Plate Switches - Wireless and Hardwired (continued)

Distributor Discount Code **CK LIST**

ADA Compliant



**4 1/2" Round Push Plate Switch**

- Pressing any part of the push plates 4" 1/2 active area causes switch actuation
- 1 Gang or 2 gang recessed or Surface Box Mount • Depth: SPDT 5/8" deep; DPDT 1 1/2" deep

SPDT Model	Description	Price	DPDT Model	Description	Price
48204RU	Push to Open, black infill	85.00	48404RU	Push to Open, black infill	110.00
482A4RU	♿ Push to Open, blue infill	85.00	484A4RU	♿ Push to Open, blue infill	110.00
480-4RSB	Surface box, 5" Dia., 2 1/8" O.D.	56.00	480-4RFB	Black Flush Escutcheon, 5 7/8" overall diameter with trim ring	63.00
480-4RG	4" round gasket	15.00	480-4RRB	Surface Escutcheon, 7 7/8" Dia., 1 9/16" overall height	63.00



**6" Round Push Plate Switch**

- Pressing any part of the push plates 6" active area causes switch actuation
- 1 Gang or 2 gang recessed or Surface Box Mount • Depth: SPDT 5/8" deep; DPDT 1 1/2" deep

SPDT Model	Description	Price	DPDT Model	Description	Price
48206RU	Push to Open, black infill	90.00	48406RU	Push to Open, black infill	114.00
482A6RU	♿ Push to Open, blue infill	90.00	484A6RU	♿ Push to Open, blue infill	114.00
480-6RSB	Surface box Round, 6 7/16" Dia., 2 1/8" O.D.	56.00	480-6RFB	Recessed Flush Escutcheon, 7 3/4" overall diameter with trim ring	63.00
480-6RG	6" round gasket	15.00			

## 480 Series Touch Panel Column - Wireless & Hardwire

Distributor Discount Code **CK**

### Applications

- Wireless & Hardwire
- ADA Ingress/R.E.X/Egress Door Opener Activation
- Access Control Request-to-Exit (REX)
- Door Opener Activation
- Automatic Door Activation or Lock Release
- Automatic Door & Exit Device Sequencer Activation



can be used with wireless transmitter and receiver

### Features

- Surface wall mount or bollard mount
- Sleek Architectural profile
- No square edges to snag, wide sloping sides deflects impact movement naturally to activate column
- Deflects impact from wheeled carts and conveyances
- Impact & Vandal resistant design, inhibits prying, tampering
- Weather Resistant, no gaps for water or ice penetration
- Choice of SPDT or DPDT, 15 Amps @ 125/250VAC

### 9" X 6" INGRESS-R.E.X TOUCH PANEL COLUMN

List

**Fully Active 22-1/2 Sq. Inch Actuation Area**  
Recommended Centerline mounting height 34" to 48"

**Material:** Sturdy 1/8" extrusion with architectural finish  
**Overall Size:** 9" h x 6" w x 1-1/2" d (229 x 152 x 38mm)  
**Active Area:** 9" h x 2-1/2" w (229 x 63.5mm)

SPDT Model	Description	Price
482AA9	♿ Push to Open	292.00
<b>SPECIFY FINISH</b>		
V 628 Aluminum (standard), blue infill	N/C	X 613 Dark Bronze, white infill
		24.00

Add to List

### 36" X 6" INGRESS-R.E.X TOUCH PANEL COLUMN

List

**Fully Active 90 Sq. Inch Actuation Area**  
Recommended mounting height is 3" from floor

**Material:** Sturdy 1/8" extrusion with architectural finish  
**Overall Size:** 36" h x 6" w x 1-1/2" d (914 x 152 x 38mm)  
**Active Area:** 36" h x 2-1/2" w (914 x 63.5mm)

SPDT Model	Description	Price	DPDT Model	Description	Price
482AA36	♿ Push to Open	404.00	484AA36	♿ Push to Open	430.00
<b>SPECIFY FINISH</b>					
V 628 Aluminum (standard), blue infill			X 613 Dark Bronze, white infill		N/C

Add to List



SDG

SECURITY DOOR CONTROLS  
801 Avenida Acaso • Camarillo, CA 93012  
Email: Service@sdgsecurity.com • www.sdgsecurity.com

Price List Effective February 1, 2017