

SDC Security Door Controls

801 Avenida Acaso, Camarillo, Ca. 93012 • (805) 494-0622 •
 www.sdcsecurity.com • E-mail: service@sdsecurity.com

1291ADMR INSTALLATION INSTRUCTIONS/TEMPLATE MECHANICAL RELEASE

ALUMINUM FRAME MOUNT CONFIGURATION

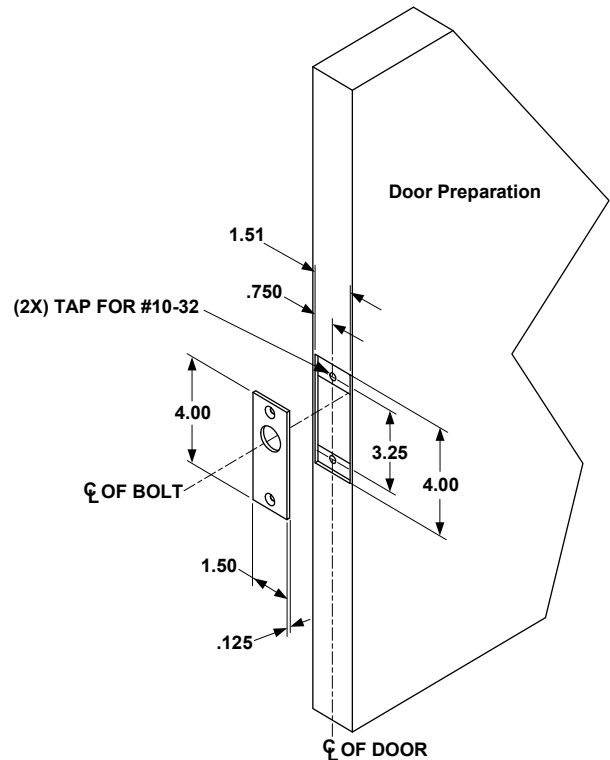
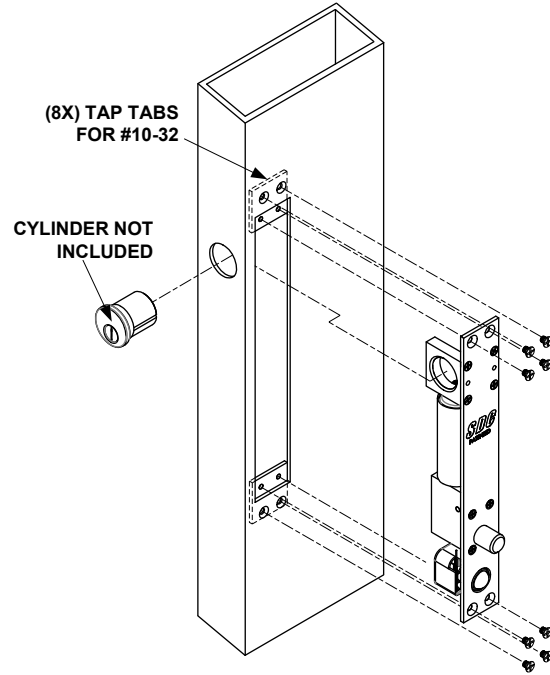
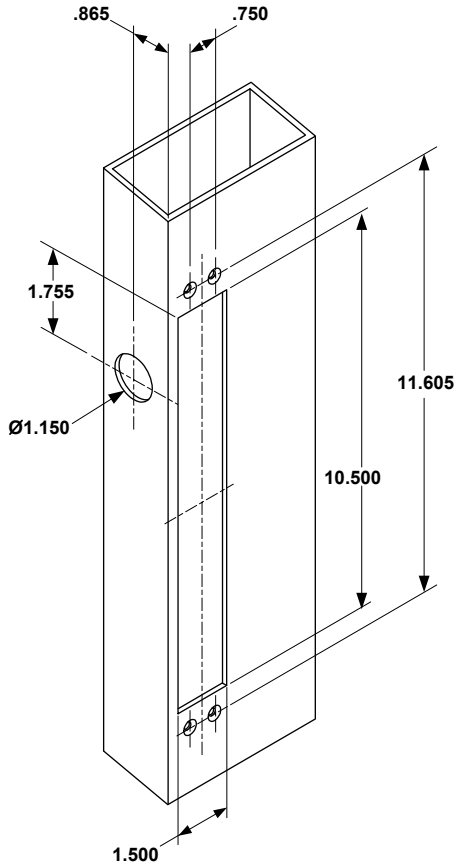

NOTE: TEMPLATE DIMENSIONS ARE SUBJECT TO CHANGE WITHOUT NOTICE.

TECHNICAL DATA (FOR STANDARD UNIT)
FACE PLATE: 10-1/2" x 1-1/2" X 1/8"
STRIKE: 4" x 1-1/2" x 1/8"
ID REQUIREMENTS: 10-1/2" x 1-1/2" x 1-1/2"
BOLT: 5/8" DIA. STAINLESS STEEL
BOLT THROW: 5/8"

Any suggestions or comments to this instruction or product are welcome. Please contact us through our website or email engineer@sdsecurity.com

HOLLOW METAL FRAME MOUNT CONFIGURATION

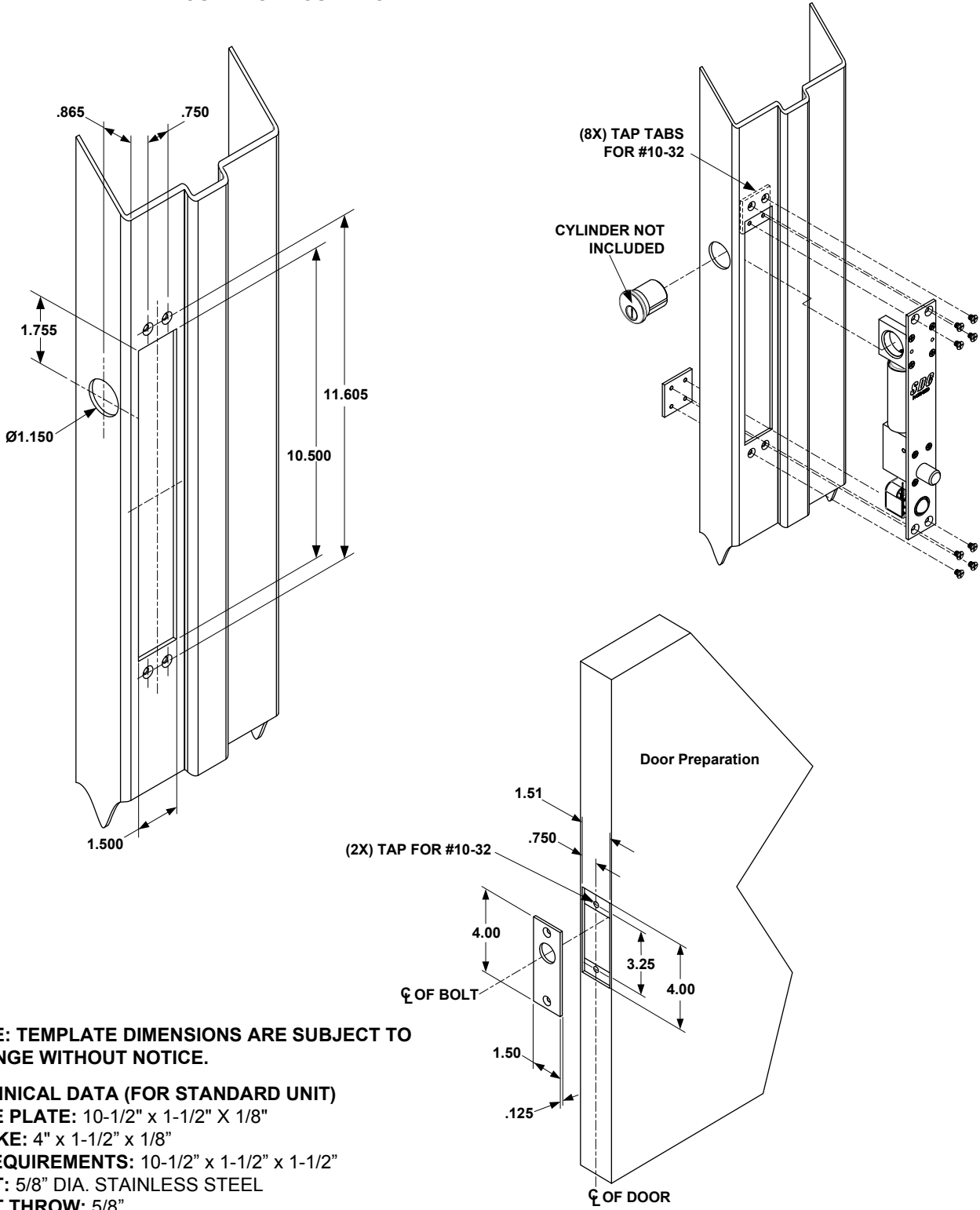

NOTE: TEMPLATE DIMENSIONS ARE SUBJECT TO CHANGE WITHOUT NOTICE.

TECHNICAL DATA (FOR STANDARD UNIT)

FACE PLATE: 10-1/2" x 1-1/2" X 1/8"

STRIKE: 4" x 1-1/2" x 1/8"

ID REQUIREMENTS: 10-1/2" x 1-1/2" x 1-1/2"

BOLT: 5/8" DIA. STAINLESS STEEL

BOLT THROW: 5/8"

DOOR MOUNT CONFIGURATION

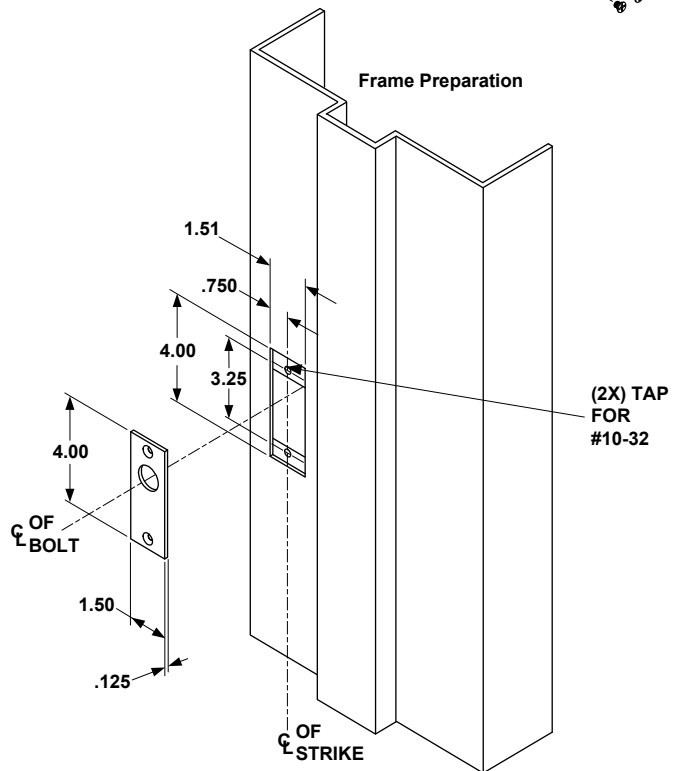
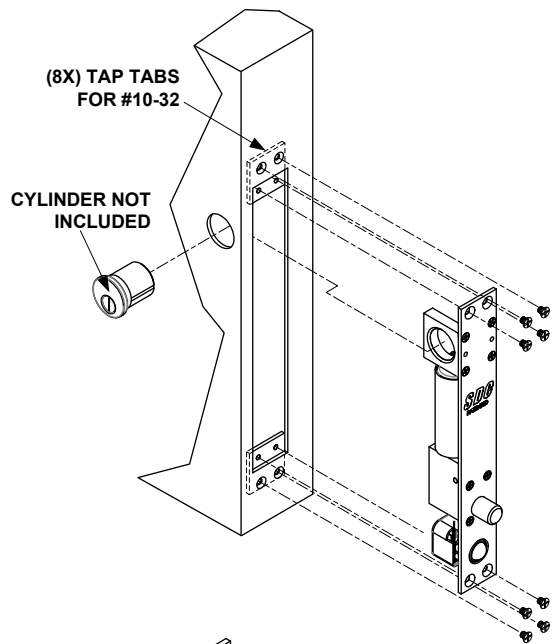
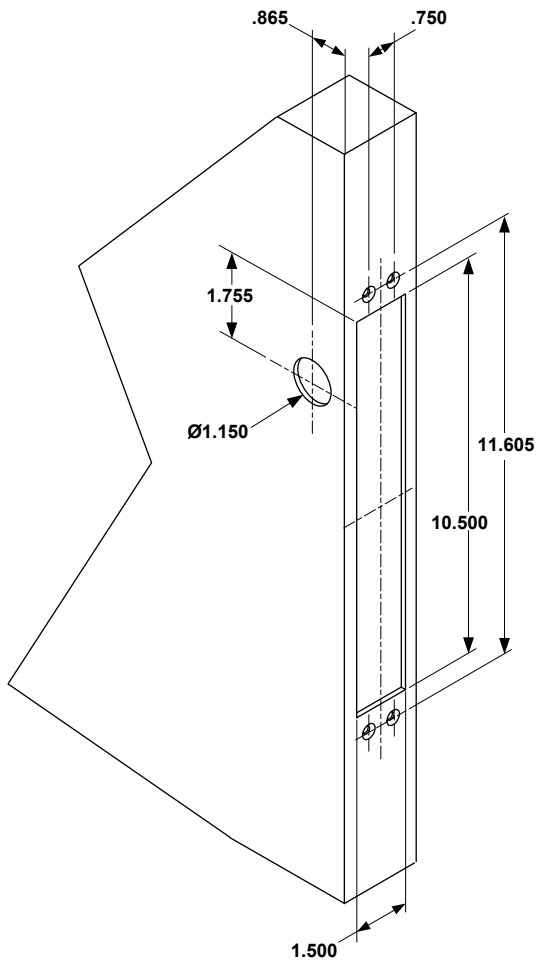

NOTE: TEMPLATE DIMENSIONS ARE SUBJECT TO CHANGE WITHOUT NOTICE.

TECHNICAL DATA (FOR STANDARD UNIT)

FACE PLATE: 10-1/2" x 1-1/2" X 1/8"

STRIKE: 4" x 1-1/2" x 1/8"

ID REQUIREMENTS: 10-1/2" x 1-1/2" x 1-1/2"

BOLT: 5/8" DIA. STAINLESS STEEL

BOLT THROW: 5/8"

INSTRUCTIONS FOR REVERSING THE CYLINDER

Cylinder
Locking
Set Screw

Remove the Cylinder locking set screw, and screw the
Cylinder out of the Mounting Block.

Remove the four screws securing the Mounting Block
and the Sliding Link Block.

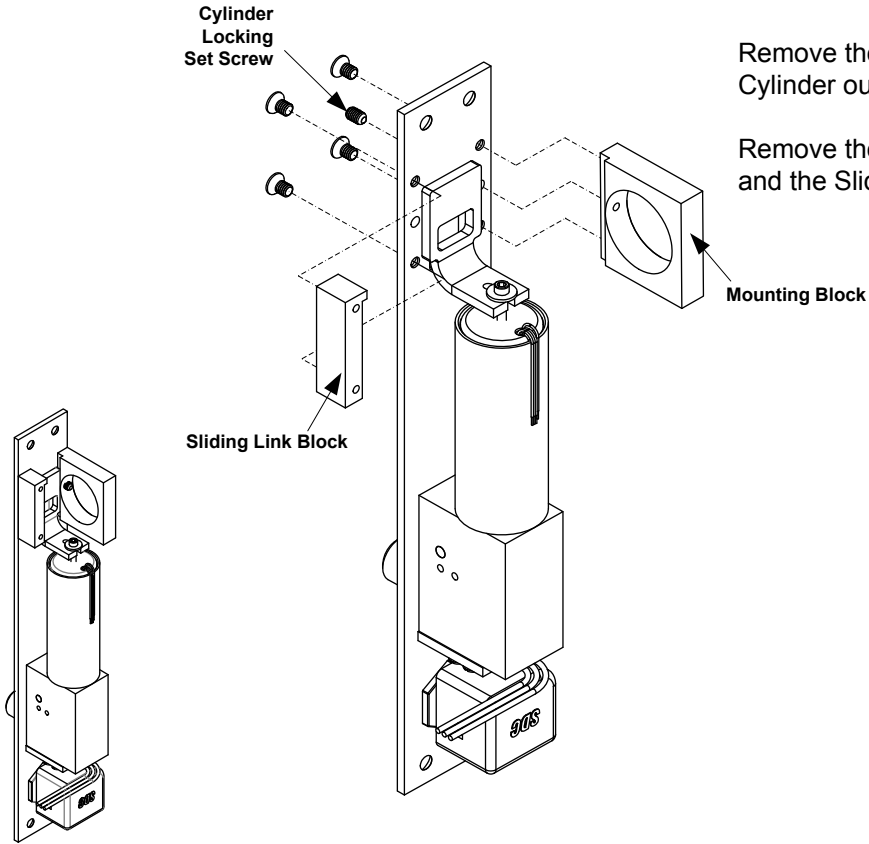

Sliding Link Block

Mounting Block

Reverse the components and
re-install as shown.

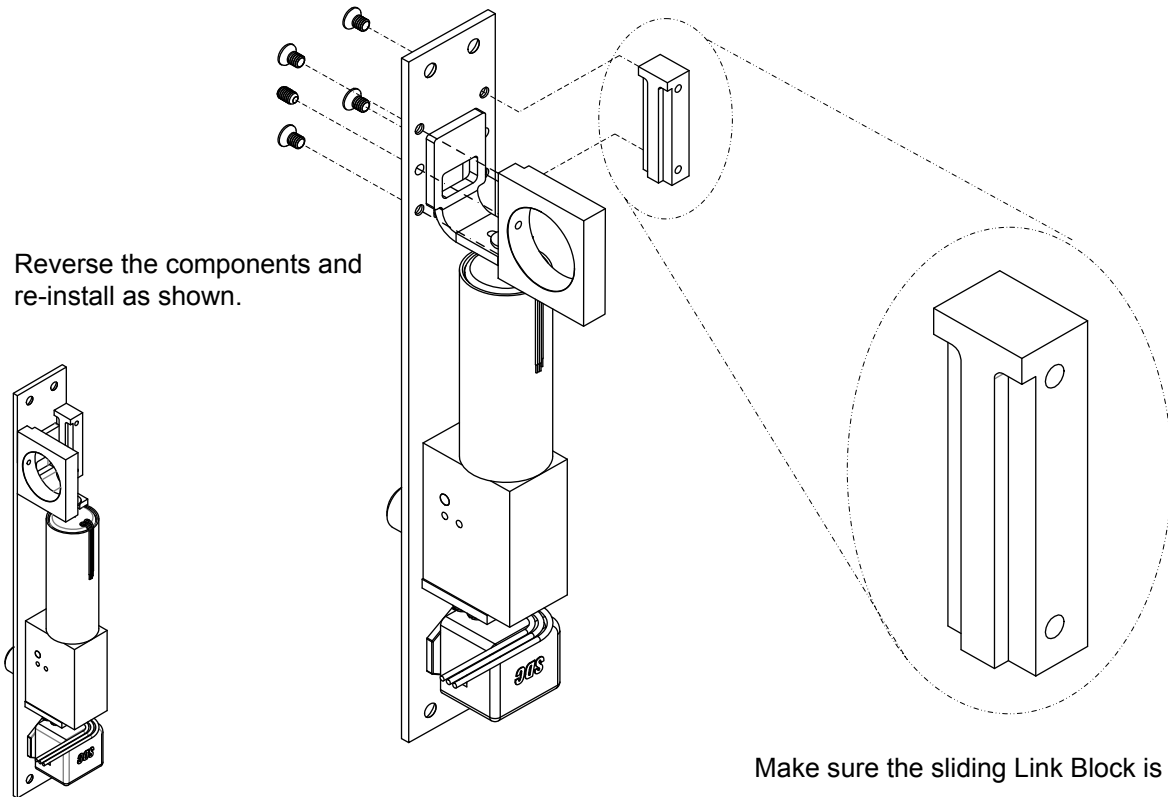

Make sure the sliding Link Block is aligned properly

LOCK WIRING

Select 24VDC OR 12VDC Configuration, and use provided pigtail connector:

24VDC SOLENOID CONFIGURATION

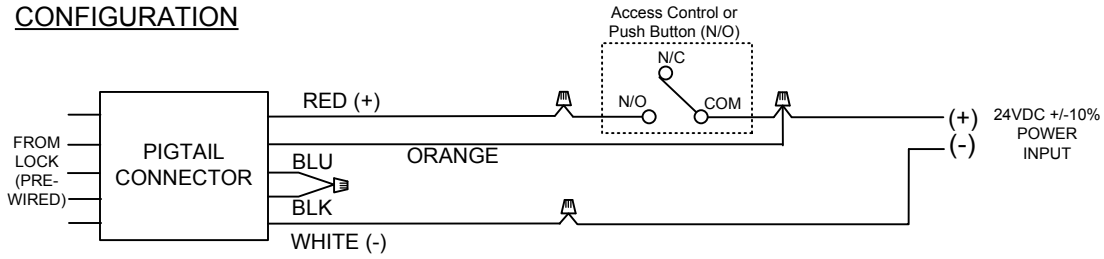

ELECTRICAL DATA:
Dual Voltage Solenoid
 12VDC @ .9 mA (max.)
 24VDC @ .45 mA (max.)
 Continuous Duty

12VDC SOLENOID CONFIGURATION

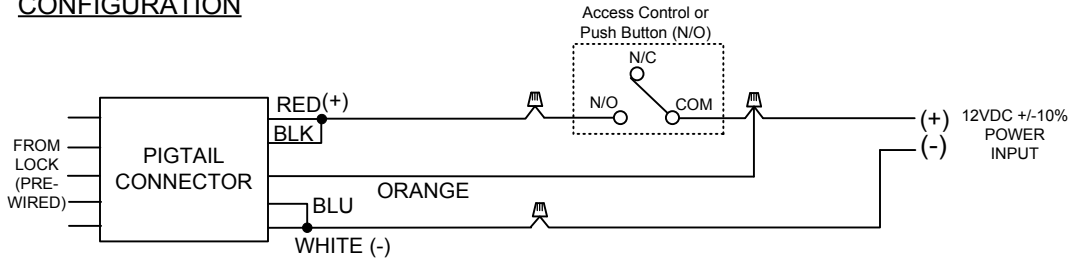

OPTIONAL BOLT POSITION SENSOR (BPS-MAGNETIC)		
B	Indicates bolt locked or unlocked	5 Watt
OPTIONAL DOOR POSITION SWITCH (DPS-MECHANICAL)		
D	Indicates door opened or closed	4A @ 30VDC (Resistive)

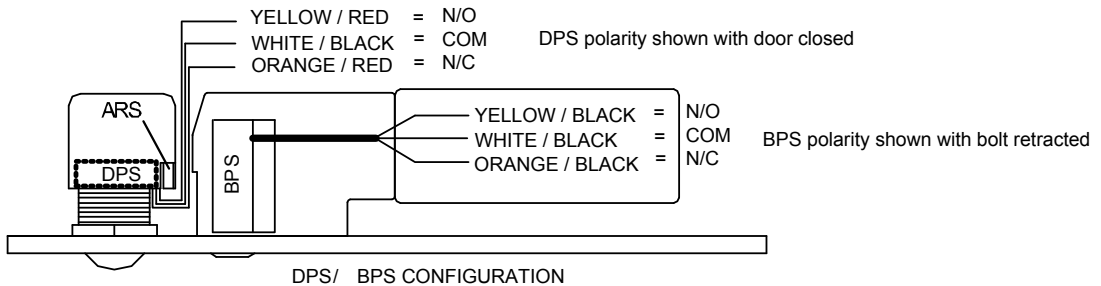

*When both options are ordered the Common is shared