

GWXT Auxiliary Locks  
CVXJ Burglary Resistant Electrically Operated Door Lock

**UL10C** Positive Pressure Compliant  
**UBC** Classified in accordance with Uniform Building Code standard 7-2 "Fire Test for Door Assemblies"

**1510 Series Grade 1**  
1650 lb / 748 Kg Holding Force

ELECTRICAL SPECIFICATIONS

**Voltage:** 12/24VDC Voltage Sensing Input  
**Single:** 350mA @ 24VDC; 670mA @ 12VDC  
**Double:** 700mA @ 24VDC; 1.34A @12VDC

MECHANICAL SPECIFICATIONS

**Single:** 11" L x 2.75" H x 1.562" D  
(279.4 x 69.9 x 39.7 mm)  
**Double:** 22" L x 2.75" H x 1.562" D  
(558.8 x 69.9 x 39.7 mm)

**1570 Series Grade 1**  
1200 lb / 544 Kg Holding Force

ELECTRICAL SPECIFICATIONS

**3 Watt Power Saver**  
**Voltage:** 12/24VDC Voltage Sensing Input  
**Single:** 125mA @ 24VDC; 250mA @ 12VDC  
**Double:** 250mA @ 24VDC; 500mA @ 12VDC

MECHANICAL SPECIFICATIONS

**Single:** 11" L x 2.75" H x 1.562" D  
(279.4 x 69.9 x 39.7 mm)  
**Double:** 22" L x 2.75" H x 1.562" D  
(558.8 x 69.9 x 39.7 mm)

**1580 Series Grade 1**  
650 lb / 295 Kg Holding Force

ELECTRICAL SPECIFICATIONS

**Voltage:** 12/24VDC Voltage Sensing Input  
**Single:** 220mA @ 24VDC; 440mA @ 12VDC  
**Double:** 440mA @ 24VDC; 880mA @ 12VDC

MECHANICAL SPECIFICATIONS

**Single:** 8.75" L x 2.125" H x 1.25" D  
(222.2 x 54 x 31.8 mm)  
**Double:** 17.5" L x 2.125" H x 1.25" D  
(444.5 x 54 x 31.8 mm)

**UL294** : Standard for Access Control System Units

EMLOCK® MODELS

Distributor Discount Code **GK** LIST

**1650lb / 748 kg Holding Force, Automatic Voltage Sensing Input**

|             |  |               |
|-------------|--|---------------|
| <b>1511</b> | Single EmLock®                                   | <b>480.00</b> |
| <b>1512</b> | Double EmLock®                                   | <b>960.00</b> |
| <b>1513</b> | Single EmLock®, split armature for pair of doors | <b>539.00</b> |

**1200lb / 544 kg Holding Force, Automatic Voltage Sensing Input**

|             |  |               |
|-------------|--|---------------|
| <b>1571</b> | Single EmLock®                                   | <b>449.00</b> |
| <b>1572</b> | Double EmLock®                                   | <b>907.00</b> |
| <b>1573</b> | Single EmLock®, split armature for pair of doors | <b>507.00</b> |

**650lb / 295 kg Holding Force, Automatic Voltage Sensing Input**

|             |                |               |
|-------------|----------------|---------------|
| <b>1581</b> | Single EmLock® | <b>374.00</b> |
| <b>1582</b> | Double EmLock® | <b>737.00</b> |

SPECIFY FINISH

Add to List

| Anodized Finishes (Architectural Housing: Add 21.00 per foot to base)   |   | Single EmLock | Double Emlock |
|---|---|---------------|---------------|
| <b>V</b>  | 628 Aluminum (standard)                         | N/C           | N/C           |
| <b>Y</b>  | 335 Black                                       | <b>86.00</b>  | <b>129.00</b> |
| Powder Coat Finishes (a coating electrostatically applied to form a hard finish, that is tougher than conventional paint) |   |               |               |
| <b>X</b>  | Dark Bronze Powder Coat Painted (313/613 Equal) | <b>86.00</b>  | <b>129.00</b> |
| <b>C</b>  | Brass Powder Coat Painted                       | <b>86.00</b>  | <b>129.00</b> |
| Plated Finishes - Special order, no cancellation, no returns  |   |               |               |
| <b>P</b>  | 625 Bright Chrome                               | <b>203.00</b> | <b>235.00</b> |
| <b>Q</b>  | 626 Dull Chrome                                 | <b>203.00</b> | <b>235.00</b> |

Architectural Housing add \$30 per foot to above Single Unit Price.



1575U  
see page 16



1576U  
see page 16



# EMLock® Magnetic Locks

## SPECIFY OPTIONS

List

See Modular Program price list when ordering separately for field upgrades. Different part numbers and pricing apply.

|          |  |              |
|----------|--|--------------|
| <b>T</b> | Adjustable timer. Built in field adj. 0-30 sec. relock delay.<br><b>Specify one for single or double EmLocks® (not available with 1580 series)</b>   | <b>70.00</b> |
| <b>D</b> | Door position sensor. Indicates door open and door closed.<br><b>Specify two for double EMLocks® (not available with 1513 and 1573)</b><br>SPDT Dry, 250 mA @ 30VDC.   | <b>44.00</b> |
| <b>B</b> | Magnetic bond sensor. Indicates locked with full holding power and unlocked, low holding power, low voltage, tampering and obstruction between armature and magnetic core.<br><b>Specify (2) for double EmLocks® (Not available with 1513 and 1573)</b> <ul style="list-style-type: none"> <li>1510 &amp; 1570 Series: SPDT Dry, 250 mA @ 30VDC.</li> <li>1580 Series: SPST N.O., Dry, 250 mA @ 30VDC.</li> </ul>  | <b>65.00</b> |
| <b>L</b> | Bi-color status LED indicator. Field selectable Red and Green. (Not installed in lock.)<br>Indicates lock energized when wired to lock input.<br>Indicates de-energized/unlocked <b>or</b> "Enter/Go" when wired to built-in TD Module<br>Indicates energized <b>and</b> de-energized <b>or</b> "Enter/Go" when wired to access control auxiliary output.<br>Indicates door is closed <b>and</b> locked <b>and</b> door is unlocked when wired to Bond Sensor. | <b>18.00</b> |
| <b>A</b> | Anti-tamper sensor. Indicates access cover removal.<br>SPDT Dry, 1 Amp @ 30VDC   | <b>54.00</b> |

## SPECIFY TOP JAMB MOUNTING KIT

Distributor Discount Code **GK** LIST

| Kits for 1200lb and 1650 lb Locks |        | Kits for 650lb Locks |        |               |
|-----------------------------------|--------|----------------------|--------|---------------|
| <b>TJ1</b>                        | Single | <b>TJ81</b>          | Single | <b>129.00</b> |
| <b>TJ2</b>                        | Double | <b>TJ82</b>          | Double | <b>210.00</b> |

Add to List

## Anodized Finishes

|          |                    |            | Single Top Jamb | Double Top Jamb |
|----------|--------------------|------------|-----------------|-----------------|
| <b>V</b> | 628 Aluminum (std) | <b>N/C</b> | <b>86.00</b>    | <b>171.00</b>   |

**Powder Coat Finishes** (a coating electrostatically applied to form a hard finish, that is tougher than conventional paint)

|          |                                 |          |                           |              |               |
|----------|---------------------------------|----------|---------------------------|--------------|---------------|
| <b>X</b> | Dark Bronze Powder Coat Painted | <b>C</b> | Brass Powder Coat Painted | <b>86.00</b> | <b>171.00</b> |
|----------|---------------------------------|----------|---------------------------|--------------|---------------|

**Plated Finishes - Special order, no cancellation, no returns**

|          |                   |          |                 |               |               |
|----------|-------------------|----------|-----------------|---------------|---------------|
| <b>P</b> | 625 Bright Chrome | <b>Q</b> | 626 Dull Chrome | <b>203.00</b> | <b>235.00</b> |
|----------|-------------------|----------|-----------------|---------------|---------------|

Add to List

## SPECIFY GLASS DOOR MOUNTING KIT

Distributor Discount Code **GK** List

- Universal glass door kits are compatible with lock models, except 1513 and 1573
- Field adjustable for 1/2", 5/8" and 3/4" all glass Herculite doors

| Kits for 1511, 1571, 1581 |        | Kits for 1512, 1572, 1582 |             |                       |               |
|---------------------------|--------|---------------------------|-------------|-----------------------|---------------|
| <b>HDB1</b>               | Single | <b>193.00</b>             | <b>HDB2</b> | Double, 2 single kits | <b>385.00</b> |

Add to List

## Anodized Finishes

|          |                    |            | Single       | Double        |
|----------|--------------------|------------|--------------|---------------|
| <b>V</b> | 628 Aluminum (std) | <b>N/C</b> | <b>86.00</b> | <b>171.00</b> |

**Powder Coat Finishes** (a coating electrostatically applied to form a hard finish, that is tougher than conventional paint)

|          |                                 |          |                           |              |               |
|----------|---------------------------------|----------|---------------------------|--------------|---------------|
| <b>X</b> | Dark Bronze Powder Coat Painted | <b>C</b> | Brass Powder Coat Painted | <b>86.00</b> | <b>171.00</b> |
|----------|---------------------------------|----------|---------------------------|--------------|---------------|

**Plated Finishes - Special order, no cancellation, no returns**

|          |                   |          |                 |               |               |
|----------|-------------------|----------|-----------------|---------------|---------------|
| <b>P</b> | 625 Bright Chrome | <b>Q</b> | 626 Dull Chrome | <b>108.00</b> | <b>214.00</b> |
|----------|-------------------|----------|-----------------|---------------|---------------|

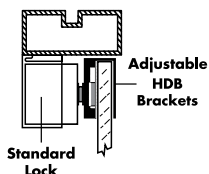
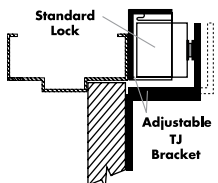

### Field Upgrade without Removing from the Frame

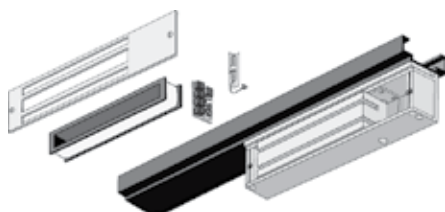

#### Field Install

- Monitoring outputs
- Timers
- Top jamb "Z" kit
- Glass door kits

### Interlocking Quick Mount Assembly

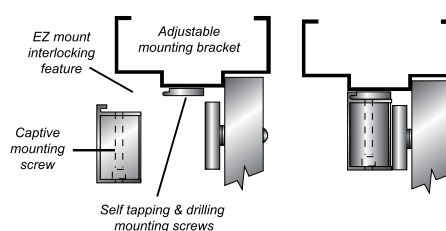

# EMLock® Magnetic Locks



## Vertical Housing EMLock

Distributor Discount Code **GK**

**LIST**

**Vertical Housings** - Side jamb mount, provides 2,400 or 3,300 lbs. of holding force.

|                 |   |                |
|-----------------|---|----------------|
| <b>1572VV82</b> | Vertical Housing for 1572 EMLock, 82" length, for 84" opening - INCLUDES EMLock | <b>1599.00</b> |
| <b>1512VV82</b> | Vertical Housing for 1512 EMLock, 82" length, for 84" opening - INCLUDES EMLock | <b>1654.00</b> |

See page 7 for special finish designation and finish price

Custom Length (1512 or 1572)

Add to List

|           |   |                |
|-----------|---|----------------|
| <b>CV</b> | Custom length - any length OVER 82". Specify exact length | <b>1200.00</b> |
|-----------|---|----------------|

## Retrofit Kit for Discontinued Locknetics 390+ PLUS

Distributor Discount Code **GK**

**LIST**

Enables replacement of Locknetics 390+ PLUS with SDC's 1511 and 1571 (ordered separately)

|                    |   |              |
|--------------------|---|--------------|
| <b>1511-390AMP</b> | Retrofit Kit includes lock mounting plate with self-tapping & drilling screws and Armature assembly, utilizes existing 390+ thru-bolt hole. | <b>54.00</b> |
|--------------------|---|--------------|

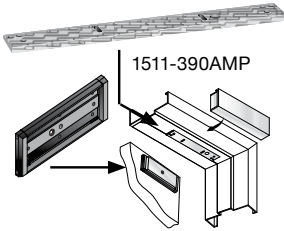

## Field Installed Modular Upgrade Kits

Ordered separately for field upgrade without removing the lock from the frame

For complete details contact SDC to request the Modular Upgrade Kit datasheet or download from the SDC website: [www.sdcsecurity.com](http://www.sdcsecurity.com) All available through shipQuick Inventory

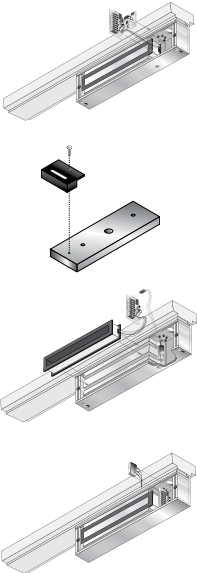

|  |              |  |              |
|--|--------------|--|--------------|
| <b>EZ-T-10 Adjustable Timer Input Module:</b>                              | <b>70.00</b> | <b>EZ-A Anti-Tamper Switch Module:</b>   | <b>54.00</b> |
| Specify (1) for single or double EmLocks® (not available with 1580 series) |              | Indicates cover plate removal.   |              |
| <b>EZ-D-10 1510, 1570 Door Position Sensor Module:</b>                     | <b>44.00</b> | <b>EZ-1510W Holding Force Module:</b>  | <b>54.00</b> |
| Specify (2) for double EmLocks® (not available with 1513 and 1573)         |              | Replace a 1200lb wire core (1570 series) with this 1650lb wire core. Specify (2) for double EmLocks®   |              |
| <b>EZ-D-80 1580 Door Position Sensor Module:</b>                           | <b>44.00</b> | <b>EZ-1570W Energy Saver Module:</b>   | <b>54.00</b> |
| Specify (2) for double EmLocks®  |              | Save on power supply and long term energy costs by replacing 8.4 Watt, 1650lb coil with 3 Watt, 1200lb holding force coil. Specify (2) for double EmLocks® |              |
| <b>EZ-B-10 1510, 1570 Magnetic Bond Sensor Module:</b>                     | <b>65.00</b> |  |              |
| Specify (2) for double EmLocks® (Not available with 1513,1573)             |              |  |              |

## Reusable Heavy Duty Drill Fixture

Distributor Discount Code **G**

**LIST**



|                |  |               |
|----------------|--|---------------|
| <b>1511-DF</b> | Heavy duty drill fixture for 1571 and 1511 | <b>161.00</b> |
| <b>1581-DF</b> | Heavy duty drill fixture for 1580          | <b>161.00</b> |
| <b>BN-PT</b>   | Blind Nut Placement Tool                   | <b>129.00</b> |
| <b>BN-50</b>   | Blind Nuts, 10/32, 50 Pack                 | <b>54.00</b>  |

## Universal Header Bracket

Distributor Discount Code **GK LIST**

Used in lieu of angle brackets, the Universal Header Bracket provides a faster mounting solution, saving time and labor costs for several EmLock® models. Reduce potential for mis-sized and misaligned mounting holes, broken taps, removal of broken taps. Combined with interlocking E-Z mount assembly, save up to a half day's labor with the installation of 12 locks.

### FEATURES

- Solid 1" bar provides higher security and superior aesthetics.
- Multiple pre-drilled and tapped mounting holes to accommodate the use of several different locks on either 4" or 4.5" aluminum frames
- Machined wire chase provides concealed and secure wiring

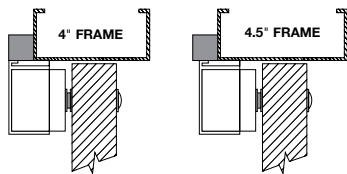

|              |   |               |
|--------------|---|---------------|
| <b>UB11V</b> | Bracket for 1511, 1513, 1571. 1" x 1" x 11" | <b>70.00</b>  |
| <b>UB12V</b> | Bracket for 1512, 1572. 1" x 1" x 22"       | <b>137.00</b> |

See special finishes page 11



## Aluminum Spacer Bracket & Concrete Filled Frame Plate - Pre-Drilled & Tapped **GK LIST**

### APPLICATION

- Aluminum frames with blade stop - lowers EmLock® below blade stop
- Concrete filled hollow metal frames - provides multiple points for concealed wire entry

### FEATURES

- Pre-drilled and tapped specifically for 1510, 1570, 1580 EmLock
- Machined wire chase provides multiple points for concealed wire entry from concrete filled frames.

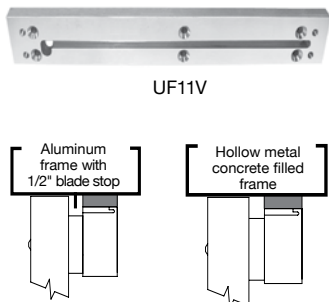

|              |   |               |
|--------------|---|---------------|
| <b>UF11V</b> | Bracket for 1511, 1513, 1571, 1573. 1/2" x 1-1/2" x 11" | <b>97.00</b>  |
| <b>UF12V</b> | Bracket for 1512 and 1572. 1/2" x 1-1/2" x 22"          | <b>120.00</b> |
| <b>UF81V</b> | Bracket for 1581. 1/2" x 1-1/4" x 8-3/4"                | <b>78.00</b>  |
| <b>UF82V</b> | Bracket for 1582. 1/2" x 1-1/4" x 17-1/2"               | <b>108.00</b> |

## Armature Mounting Plate

Distributor Discount Code **GK LIST**

The AR Mounting plate provides a solution for mounting the EmLock® armature to the top rail of aluminum, glass, wood and hollow metal doors that do not permit the use of thru bolts. **Dimension:** 8 1/2" x 3"

### MODEL

|               |  |               |
|---------------|--|---------------|
| <b>AR11Y</b>  | Armature mounting plate (Black)<br>Specify one for models 1511, 1571, two for models 1512, 1572                  | <b>65.00</b>  |
| <b>AR11YD</b> | Armature mounting plate (black) with door sensor<br>Specify one for models 1511, 1571, two for models 1512, 1572 | <b>108.00</b> |

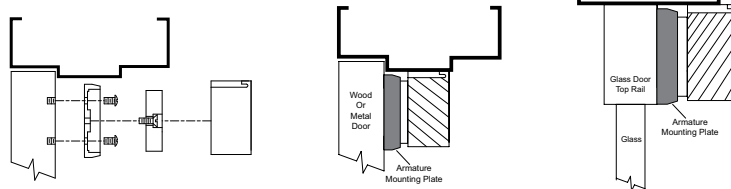

## Door Coordinator Lock Mounting Kit

Distributor Discount Code **GK LIST**

|             |  |               |
|-------------|--|---------------|
| <b>DC-1</b> | Door coordinator mounting bracket for single models 1511 and 1571. | <b>129.00</b> |
| <b>DC-2</b> | Door coordinator mounting bracket for double models 1512 and 1572. | <b>235.00</b> |

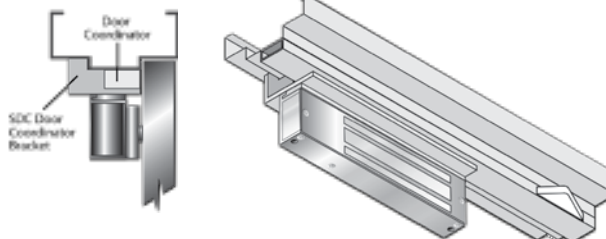

**SDG**

**SECURITY DOOR CONTROLS**  
801 Avenida Acaso • Camarillo, CA 93012  
Email: Service@sdgsecurity.com • www.sdgsecurity.com

## Filler Plates

Distributor Discount Code **GK**

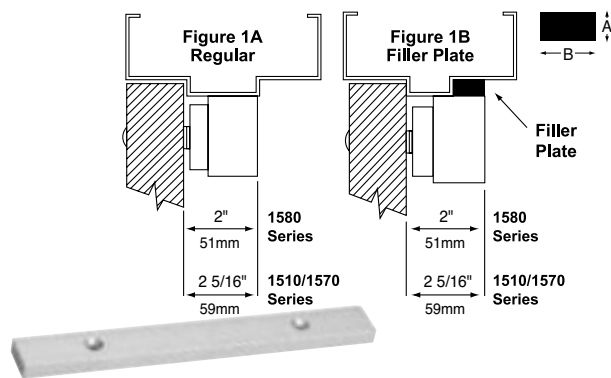

**FILLER PLATES:** For extension of the stop to provide a proper mounting surface on the underside of the header. See Figure 1B.

### FOR 8-3/4" (222mm) SINGLE EMLOCK MODELS

**GK**

1581, 1581DEV

| PART # | A x B                     | LIST  |
|--------|---------------------------|-------|
| FP01   | 1/8" x 1-1/4" (3 x 32mm)  | 33.00 |
| FP02   | 1/4" x 1-1/4" (6 x 32mm)  | 36.00 |
| FP03   | 3/8" x 1-1/4" (10 x 32mm) | 38.00 |
| FP04   | 1/2" x 1-1/4" (13 x 32mm) | 40.00 |
| FP05   | 5/8" x 1-1/4" (16 x 32mm) | 40.00 |

### FOR 11" (279mm) SINGLE EMLOCK MODELS

1511 1571 1511S 1511DEV 1581S  
1513 1573 1511T 1571DEV

| PART # | A x B                     | LIST  |
|--------|---------------------------|-------|
| FP11   | 1/8" x 1-1/4" (3 x 32mm)  | 37.00 |
| FP12   | 1/4" x 1-1/4" (6 x 32mm)  | 38.00 |
| FP13   | 3/8" x 1-1/4" (10 x 32mm) | 38.00 |
| FP14   | 1/2" x 1-1/4" (13 x 32mm) | 42.00 |
| FP15   | 5/8" x 1-1/4" (16 x 32mm) | 44.00 |

### FOR 17-1/2" (445mm) DOUBLE EMLOCK MODEL

1582

| PART # | A x B                     | LIST  |
|--------|---------------------------|-------|
| FP30   | 1/8" x 1-1/4" (3 x 32mm)  | 42.00 |
| FP31   | 1/4" x 1-1/4" (6 x 32mm)  | 44.00 |
| FP32   | 3/8" x 1-1/4" (10 x 32mm) | 46.00 |
| FP33   | 1/2" x 1-1/4" (13 x 32mm) | 48.00 |
| FP34   | 5/8" x 1-1/4" (16 x 32mm) | 50.00 |

### FOR 22" (559mm) DOUBLE EMLOCK MODELS

1512 1572

| PART # | A x B                     | LIST  |
|--------|---------------------------|-------|
| FP21   | 1/8" x 1-1/4" (3 x 32mm)  | 42.00 |
| FP22   | 1/4" x 1-1/4" (6 x 32mm)  | 44.00 |
| FP23   | 3/8" x 1-1/4" (10 x 32mm) | 46.00 |
| FP24   | 1/2" x 1-1/4" (13 x 32mm) | 48.00 |
| FP25   | 5/8" x 1-1/4" (16 x 32mm) | 50.00 |

## Angle Brackets

Distributor Discount Code **GK**

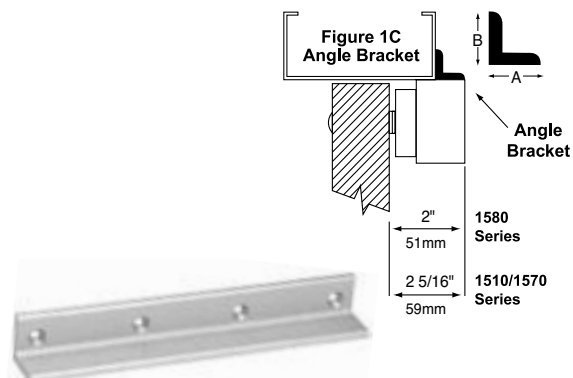

**ANGLE BRACKETS:** Used as extension on shallow door frames to provide adequate mounting surface. See Figure 1C.

### FOR 8-3/4" (222mm) SINGLE EMLOCK MODELS

**GK**

1581, 1581DEV

| PART # | A x B                       | LIST  |
|--------|-----------------------------|-------|
| AB01   | 1" x 1" (25 x 25mm)         | 42.00 |
| AB02   | 1" x 1-1/2" (25 x 38mm)     | 44.00 |
| AB03   | 1-1/2" x 1-1/2" (38 x 38mm) | 46.00 |
| AB04   | 2" x 1-1/2" (51 x 38mm)     | 48.00 |

### FOR 11" (279mm) SINGLE EMLOCK MODELS

1511 1571 1511S 1511DEV 1581S  
1513 1573 1511T 1571DEV

| PART # | A x B                       | LIST  |
|--------|-----------------------------|-------|
| AB11   | 1" x 1" (25 x 25mm)         | 44.00 |
| AB12   | 1" x 1-1/2" (25 x 38mm)     | 46.00 |
| AB13   | 1-1/2" x 1-1/2" (38 x 38mm) | 48.00 |
| AB14   | 2" x 1-1/2" (51 x 38mm)     | 50.00 |

### FOR 17-1/2" (445mm) DOUBLE EMLOCK MODEL

1582

| PART # | A x B                       | LIST  |
|--------|-----------------------------|-------|
| AB30   | 1" x 1" (25 x 25mm)         | 54.00 |
| AB31   | 1" x 1-1/2" (25 x 38mm)     | 58.00 |
| AB32   | 1-1/2" x 1-1/2" (38 x 38mm) | 63.00 |
| AB33   | 2" x 1-1/2" (51 x 38mm)     | 67.00 |

### FOR 22" (559mm) DOUBLE EMLOCK MODELS

1512 1572

| PART # | A x B                       | LIST  |
|--------|-----------------------------|-------|
| AB21   | 1" x 1" (25 x 25mm)         | 54.00 |
| AB22   | 1" x 1-1/2" (25 x 38mm)     | 58.00 |
| AB23   | 1-1/2" x 1-1/2" (38 x 38mm) | 63.00 |
| AB24   | 2" x 1-1/2" (51 x 38mm)     | 67.00 |

### SPECIFY FINISH

Add to List

|  | Single EmLock | Double EmLock |
|--|---------------|---------------|
| <b>V</b> 628 Aluminum (standard)   | N/C           | N/C           |
| <b>Y</b> 335 Black Anodized  | 33.00         | 65.00         |
| <b>Powder Coat Finishes</b> (a coating electrostatically applied to form a hard finish, that is tougher than conventional paint) |               |               |
| <b>X</b> Dark Bronze Powder Coat Painted   | 33.00         | 65.00         |
| <b>C</b> Brass Powder Coat Painted   | 33.00         | 65.00         |
| <b>Plated Finishes - Special order, no cancellation, no returns</b>  |               |               |
| <b>P</b> 625 Bright Chrome   | 33.00         | 65.00         |
| <b>Q</b> 626 Dull Chrome   | 33.00         | 65.00         |