

# 480 Series

Narrow, Square and Round Push Plates



**SDC's push plate actuators** combined with SDC's operator, bollards and locking devices allow for complete access and egress solutions for ADA compliant applications. Included are round and square push plates in various sizes and display verbiage, logo and markings. All types can be wireless or hardwired, bollard or wall mounted.

Designed specifically for handicap access, automatic door activation and request-to-exit applications. Pressing any part of plate causes switch activation.

**See related products for wireless push plate switch kits.**



## MODELS

**482** Push Plate Actuator, SPDT

**484** Push Plate Actuator, DPDT



## STANDARD FEATURES

- Entire plate surface activates switch
- SPDT or DPDT
- Round or square
- Bold debossed sign legends
- Black or blue infill
- Wireless or hardwired
- Various plate sizes for any application
- Heavy 18 gauge stainless steel plates
- Weather resistant



## APPLICATIONS



### NARROW MULLION

- Designed to flush-mount directly into narrow jamb
- Requires narrow mullion prep
- Recessed, surface box or bollard mount

**482O1U** PUSH TO OPEN, Black Infill, SPDT

**482A1U** PUSH TO OPEN, ⚡, Blue Infill, SPDT



### SINGLE GANG

- Surface box or bollard mount

**482O2U** PUSH TO OPEN, Black Infill, SPDT

**482A2U** PUSH TO OPEN, ⚡, Blue Infill, SPDT

**484O2U** PUSH TO OPEN, Black Infill, DPDT

**484A2U** PUSH TO OPEN, ⚡, Blue Infill, DPDT



### 4 1/2" SQUARE

- Recessed, surface box or bollard mount

**482O4U** PUSH TO OPEN, Black Infill, SPDT

**482A4U** PUSH TO OPEN, ⚡, Blue Infill, SPDT

**482B4U** PUSH TO OPEN, ⚡, Blue Infill, SPDT

**484O4U** PUSH TO OPEN, Black Infill, DPDT

**484A4U** PUSH TO OPEN, ⚡, Blue Infill, DPDT

**484B4U** PUSH TO OPEN, ⚡, Blue Infill, DPDT



### 4 1/2" ROUND

- Recessed, surface box or bollard mount

**482O4RU** PUSH TO OPEN, Black Infill, SPDT

**482A4RU** PUSH TO OPEN, ⚡, Blue Infill, SPDT

**482B4RU** PUSH TO OPEN, ⚡, Blue Infill, SPDT

**484O4RU** PUSH TO OPEN, Black Infill, DPDT

**484A4RU** PUSH TO OPEN, ⚡, Blue Infill, DPDT

**484B4RU** PUSH TO OPEN, ⚡, Blue Infill, DPDT



### 6" SQUARE

- Recessed, surface box or bollard mount

**482O6U** PUSH TO OPEN, Black Infill, SPDT

**482A6U** PUSH TO OPEN, ⚡, Blue Infill, SPDT

**482B6U** PUSH TO OPEN, ⚡, Blue Infill, SPDT

**484O6U** PUSH TO OPEN, Black Infill, DPDT

**484A6U** PUSH TO OPEN, ⚡, Blue Infill, DPDT

**484B6U** PUSH TO OPEN, ⚡, Blue Infill, DPDT



### 6" ROUND

- Recessed, surface box or bollard mount

**482O6RU** PUSH TO OPEN, Black Infill, SPDT

**482A6RU** PUSH TO OPEN, ⚡, Blue Infill, SPDT

**482B6RU** PUSH TO OPEN, ⚡, Blue Infill, SPDT

**484O6RU** PUSH TO OPEN, Black Infill, DPDT

**484A6RU** PUSH TO OPEN, ⚡, Blue Infill, DPDT

**484B6RU** PUSH TO OPEN, ⚡, Blue Infill, DPDT



*All except narrow DPDT can be used with wireless transmitter and receiver. See related products.*



## SPECIFICATIONS

	<b>482O1U</b> <b>482A1U</b>	<b>482O2U</b> <b>482A2U</b> <b>484O2U</b> <b>484A2U</b>	<b>482O4U</b> <b>482A4U</b> <b>482B4U</b> <b>484O4U</b> <b>484A4U</b> <b>484B4U</b>	<b>482O4RU</b> <b>482A4RU</b> <b>482B4RU</b> <b>484O4RU</b> <b>484A4RU</b> <b>484B4RU</b>	<b>482O6U</b> <b>482A6U</b> <b>482B6U</b> <b>484O6U</b> <b>484A6U</b> <b>484B6U</b>	<b>482O6RU</b> <b>482A6RU</b> <b>482B6RU</b> <b>484O6RU</b> <b>484A6RU</b> <b>484B6RU</b>
<b>Plate Size</b>	Narrow	Single Gang	Double Gang Square	Double Gang Round	Triple Gang Square	Triple Gang Round
<b>Faceplate</b>	18 Gauge Stainless Steel	18 Gauge Stainless Steel	18 Gauge Stainless Steel	18 Gauge Stainless Steel	18 Gauge Stainless Steel	18 Gauge Stainless Steel
<b>Dimensions</b>	4½" x 1¹¹⁄₁₆"	4½" x 2¾"	4½" x 4½"	4½"	6" x 6"	6"
<b>Mounting</b>	Recessed, surface box or bollard	Recessed, surface box or bollard	Single or double gang recessed, surface box or bollard	Single gang recessed, surface box or bollard	Single or double gang recessed, surface box or bollard	Single or double gang recessed, surface box or bollard
	<b>482O1U</b> <b>482A1U</b>	<b>482O2U</b> <b>482A2U</b>	<b>482O4U</b> <b>482A4U</b> <b>482B4U</b>	<b>482O4RU</b> <b>482A4RU</b> <b>482B4RU</b>	<b>482O6U</b> <b>482A6U</b> <b>482B6U</b>	<b>482O6RU</b> <b>482A6RU</b> <b>482B6RU</b>
<b>Contact</b>	SPDT	SPDT	SPDT	SPDT	SPDT	SPDT
<b>Rating</b>	1 Amp @ 28 VDC Resistive	2 Amp @ 48 VDC Resistive	2 Amp @ 48 VDC Resistive	2 Amp @ 48 VDC Resistive	2 Amp @ 48 VDC Resistive	2 Amp @ 48 VDC Resistive
<b>Type</b>	Momentary (MO)	Momentary (MO)	Momentary (MO)	Momentary (MO)	Momentary (MO)	Momentary (MO)
<b>Depth</b>	⅞"	⅞"	⅞"	⅞"	⅞"	⅞"
		<b>484O2U</b> <b>484A2U</b>	<b>484O4U</b> <b>484A4U</b> <b>484B4U</b>	<b>484O4RU</b> <b>484A4RU</b> <b>484B4RU</b>	<b>484O6U</b> <b>484A6U</b> <b>484B6U</b>	<b>484O6RU</b> <b>484A6RU</b> <b>484B6RU</b>
<b>Contact</b>	-----	DPDT	DPDT	DPDT	DPDT	DPDT
<b>Rating</b>	-----	15 Amp @ 125/250 VAC Resistive	15 Amp @ 125/250 VAC Resistive	15 Amp @ 125/250 VAC Resistive	15 Amp @ 125/250 VAC Resistive	15 Amp @ 125/250 VAC Resistive
<b>Type</b>	-----	Momentary (MO)	Momentary (MO)	Momentary (MO)	Momentary (MO)	Momentary (MO)
<b>Depth</b>	-----	1½"	1½"	1½"	1½"	1½"



## CERTIFICATIONS

UL1054 Safety Special-Use Switches

CSA Listed



## HOW TO ORDER

### FOLLOW STEPS FOR ORDERING

Designates optional step

#### 1| SPECIFY MODEL

**482** Push Actuator, SPDT

**484** Push Actuator, DPDT

#### 3 | SPECIFY FACEPLATE

**1\*** Narrow, 4½" x 1 11⁄16"

**4** Square, 4½" x 4"½"

**4R** Round, 4½" Diameter

\* Not available with 484 models or "B" push to open signs.

#### 4| SPECIFY FINISH

**U** 630 Dull Stainless

#### 2| SPECIFY SIGN

**O** PUSH TO OPEN

**A** PUSH TO OPEN

**B** PUSH TO OPEN

**2\*** Single Gang, 2¾" x 4½"

**6** Square, 6" x 6"

**6R** Round, 6" Diameter

STEP NUMBER:	1	2	3	4
ORDERING EXAMPLE:	<b>482</b>	<b>O</b>	<b>4R</b>	<b>U</b>



## RELATED PRODUCTS

### WIRELESS TRANSMITTERS & RECEIVERS

**400RC433** 433MHz One Channel Receiver

**400W1-433** 433MHz Micro Transmitter



### NARROW MOUNTING

**480-1SB** Surface Box, 1 $\frac{3}{4}$ " x 4 $\frac{9}{16}$ " x 1 $\frac{3}{4}$ "

**480-1FB** Flush Recessed Box, 1 $\frac{3}{4}$ " x 4 $\frac{9}{16}$ " x 1 $\frac{3}{4}$ "



### 4 $\frac{1}{2}$ " AND 6" SQUARE MOUNTING

**480-SSB** Surface Box, Battery Clip, Weatherized, 5 $\frac{1}{2}$ " x 5 $\frac{1}{2}$ " x 2 $\frac{1}{8}$ "

**480-SFB** Flush Recessed Box, Battery Clip, Weatherized, 6 $\frac{3}{4}$ " x 6 $\frac{3}{4}$ " x 2 $\frac{1}{8}$ "



### SINGLE GANG MOUNTING

**480-2SB** Surface Box, 2 $\frac{3}{4}$ " x 4 $\frac{1}{2}$ " x 1 $\frac{5}{8}$ "



### 4 $\frac{1}{2}$ " ROUND MOUNTING

**480-4RSB** Surface Box, Battery Clip, 5" x 2 $\frac{1}{8}$ "

**480-4RFB** Flush Recessed Box, Battery Clip, 6 $\frac{3}{8}$ "

**480-4RG** Weather Gasket for 480-4RSB or 480-4RFB



### 6" ROUND MOUNTING

**480-6RSB** Surface Box, Battery Clip, 6 $\frac{7}{16}$ " x 2 $\frac{1}{8}$ "

**480-6RFB** Flush Recessed Box, Battery Clip, 7 $\frac{3}{4}$ "

**480-6RG** Weather Gasket for 480-6RSB or 480-6RFB



### WIRELESS PUSH PLATE SWITCH KITS

Designed to control automatic door or electrified locking hardware with wireless push plate actuators. Each kit contains two 4 $\frac{1}{2}$ " push plates (round or square), two

matching surface mount back boxes (round or square), two wireless transmitters (400W1-433, 9V) and one wireless nano receiver (400RC433). One part number covers it all.

[CLICK TO VIEW](#)

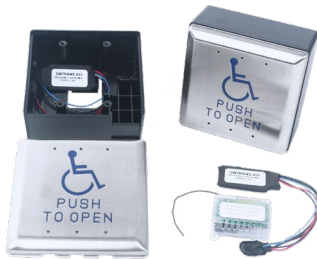

#### 482S-KIT

##### INCLUDES:

- (2) 482A4U plates
- (2) 480-SSB surface mounting boxes
- (2) 400W1-433 transmitters
- (1) 400RC433 receivers



#### 482R-KIT

##### INCLUDES:

- (2) 482A4RU plates
- (2) 480-4RSB surface mounting boxes
- (2) 400W1-433 transmitters
- (1) 400RC433 receivers

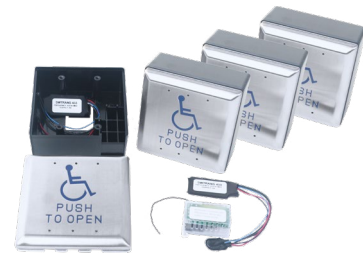

#### 482S-CBCKIT

##### INCLUDES:

- (4) 482A4U plates
- (4) 480-SSB surface mounting boxes
- (4) 400W1-433 transmitters
- (1) 400RC433 receivers

## COMPONENT CONSIDERATIONS

### LOW ENERGY OPERATORS

[CLICK TO VIEW](#)



SDC's low energy swing door operators are designed for applications requiring ADA compliance, user convenience and touchless solutions. The state-of-the-art microprocessor-based operator is self-tuning and self-learning while offering non-handed operation, full mechanical stops, door sequencing and a variety of interface options for sensors, push-plates, fire alarms and electrified locks. A built-in 1 Amp power supply allows users to power electric latch retraction directly from the operator.

### KEYPADS & READERS

[CLICK TO VIEW](#)



SDC has a variety of digital keypad and proximity card access control system equipment to meet any need. SDC's keypads and readers are engineered to provide real-world door control of a single opening up to 100 doors, such as indoor, outdoor and PC-based systems, while ensuring fire and life safety code compliance along with superior expandability and flexibility in authorization identification, authentication, access approval and accountability of entities through login credentials.

### EXIT DEVICES & RETROFIT ELR KITS

[CLICK TO VIEW](#)



SDC's exit devices provide safe and reliable security, fire and life safety, and ADA code compliance. All of our exit devices are also available with electrified options including ELR and REX capabilities as standard on selected models. With a variety of options, there is an SDC panic and fire exit device for virtually any door opening application. Our QuietDuo™ LR100 series motorized electric latch retraction retrofit kits enable electric access control and dogging of mechanical exit devices.

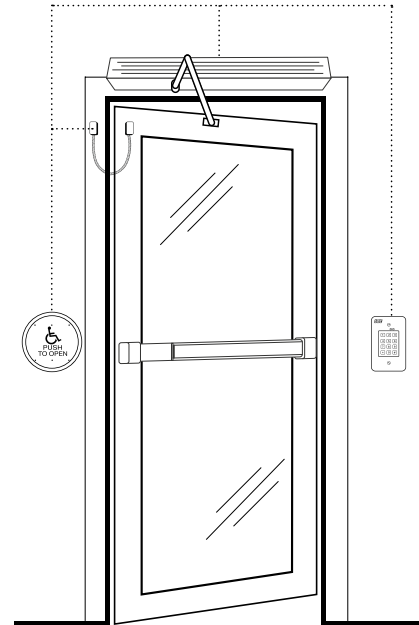

### POWER CONTROLLERS

[CLICK TO VIEW](#)



SDC access control power supplies have been developed specifically to support access controls and electric locking hardware. They are UL listed and provide filtered and regulated linear DC power, with optional control logic, component interface, alarm interface and battery back-up to meet the requirements of single and multiple access-controlled openings. The circuitry design is ideal for the inductive loads generated by access control hardware for high performance and longevity.