

INSTALLATION INSTRUCTIONS

101-SP EXTERNAL SPEAKER

1511S & 1511T – Wiring Instructions:

Using both the Internal and External Speakers simultaneously:

- Leave Internal Speaker attached to "J2" and attach bare wires from 101-SP to "EXT SPKR" Terminal Block.

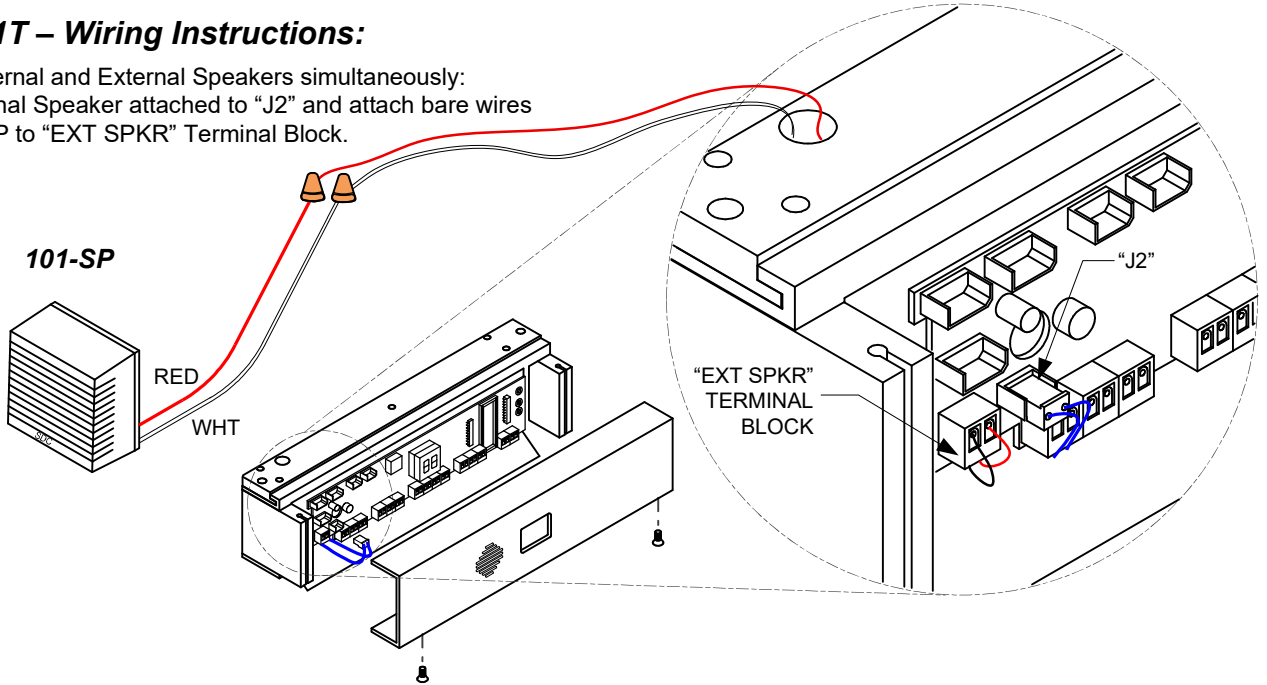

External Speaker Only:

- Replace Internal Speaker Plug from "J2" with the Pigtail Plug from 101-SP

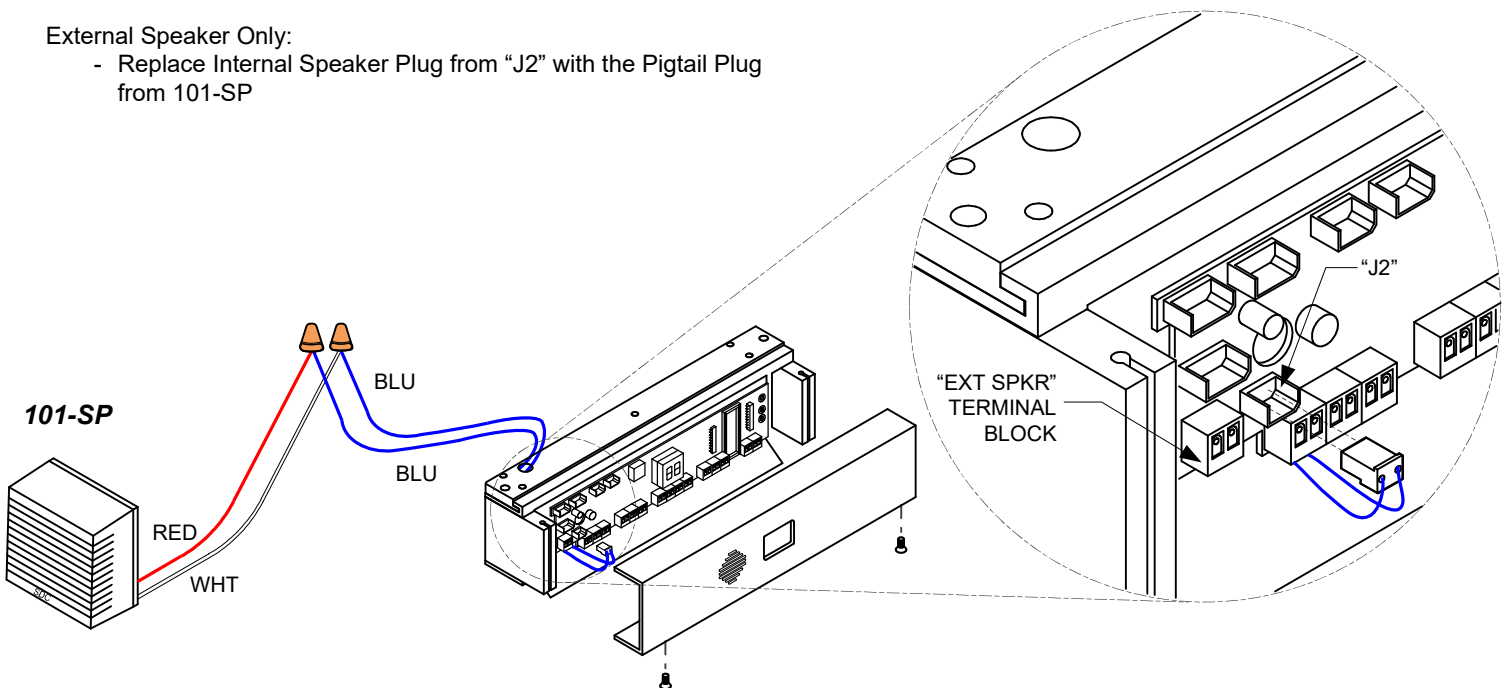



101 Controller – Wiring Instructions:

External Speaker Only:

- Replace Internal Speaker Plug from “SP1” with the Pigtail Plug from 101-SP

External Speaker w/
plug-in connector



101-SP

101 Controller

