

# INSTALLATION INSTRUCTIONS

## 7000-DGK DOOR CORE DRILLING GUIDE FOR 1-3/4" THICK DOORS

1. Mark a straight line across a piece of semi-rigid paper. This line will be the target for the Laser beam. Tape the paper to the edge of the door opposite the Hinge Cut-outs. Center the line you drew with the position you want the hole to terminate (figure 1).

**Figure 1**

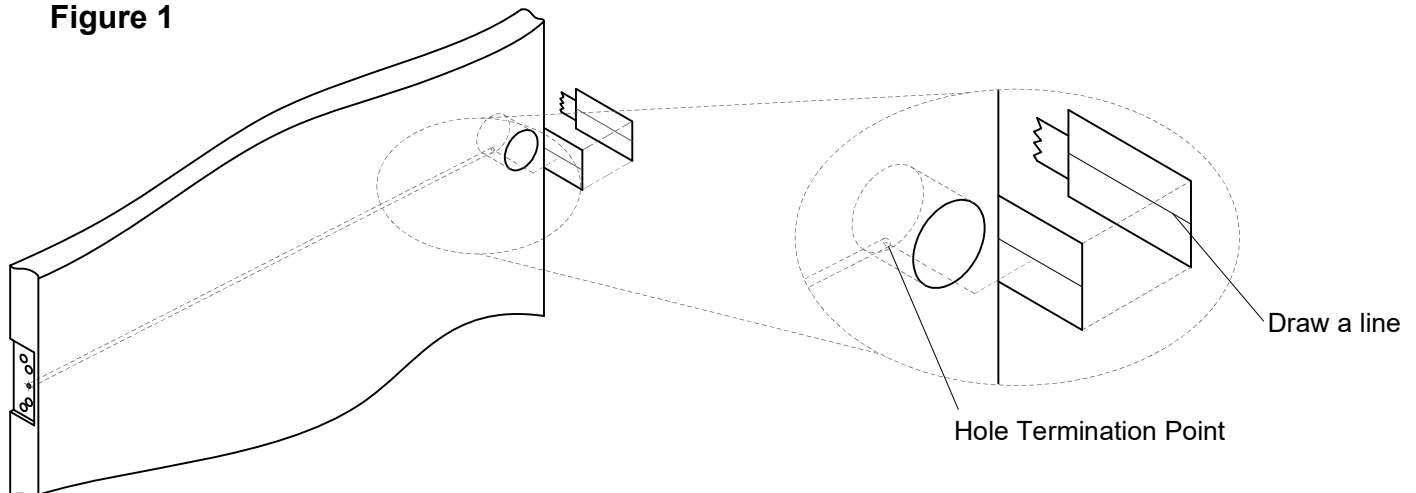

2. Place padded side of the Drill Guide against the door. Position pointed aluminum block between hinge mounting holes on the middle hinge cut-out (figure 2).

**Figure 2**

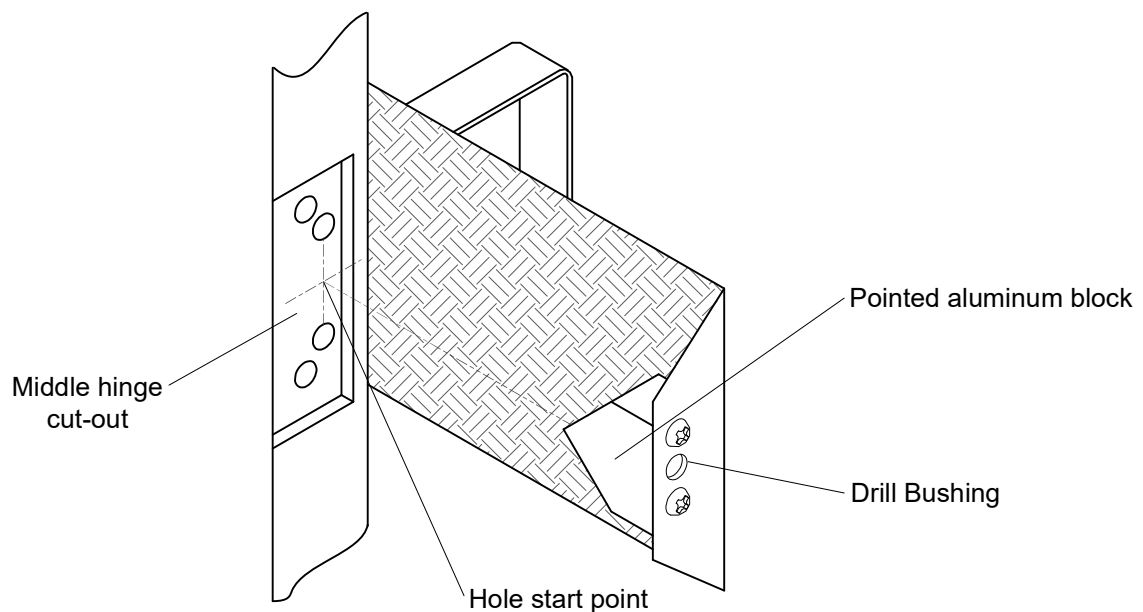

**SDC IS NOT RESPONSIBLE FOR MIS-DRILLED DOORS**

3. Turn on and aim laser at target line. If the laser beam is not aligned, refer to page 3 for laser alignment. Once the laser beam is aligned with the target, hold the Drill Guide firmly against the door. Using the provided Pilot Drill Bit (1/4" x 6"), drill a pilot hole into the door through the drill guide bushing and drill as deeply as possible (figure 3).

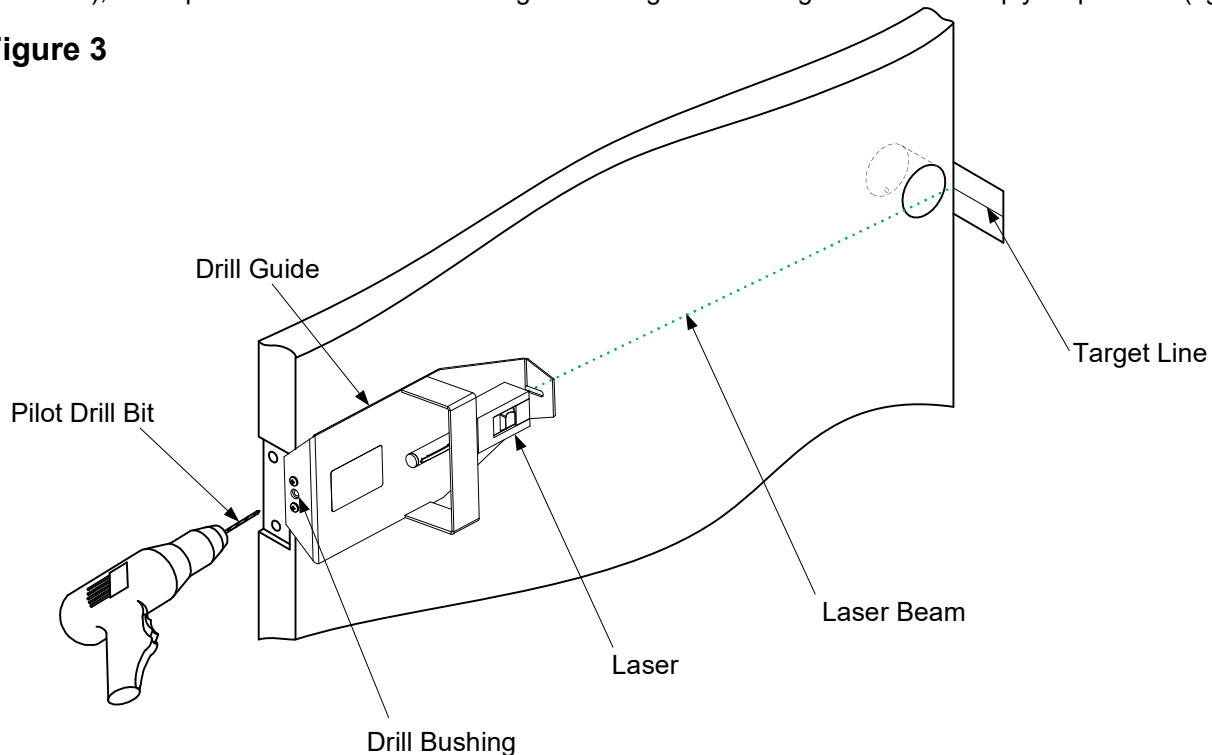
**Figure 3**

4. **Remove the Drill Guide from the door.** Using the Coring Drill Bit (3/8" x 4'), continue drilling into the pilot hole to its termination point (figure 4).

**Figure 4**

**DO NOT USE DRILL GUIDE TO CORE THE DOOR! THE CORING DRILL BIT WILL NOT FIT THROUGH DRILL GUIDE BUSHING.**

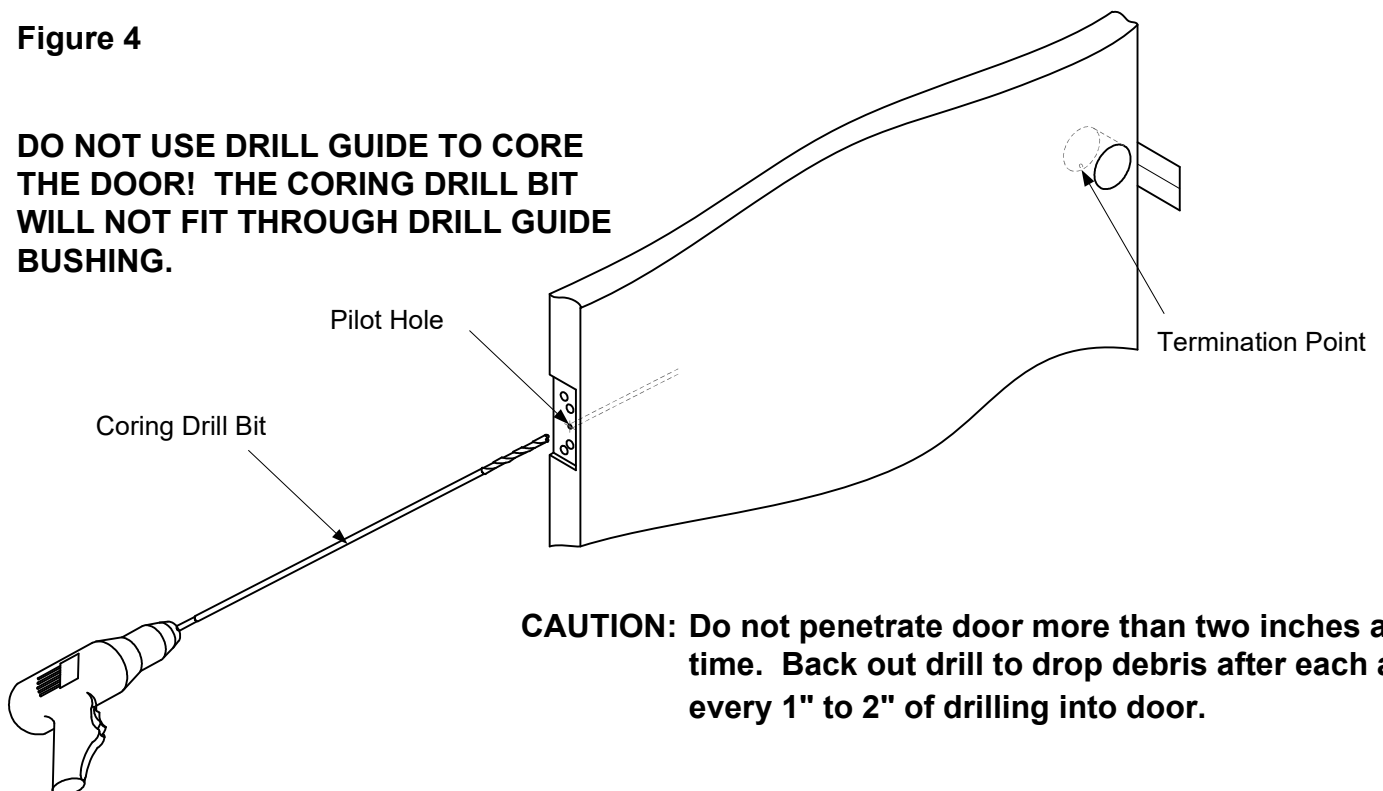

**CAUTION: Do not penetrate door more than two inches at a time. Back out drill to drop debris after each and every 1" to 2" of drilling into door.**

**SDC IS NOT RESPONSIBLE FOR MIS-DRILLED DOORS**

5. **Laser Alignment:** Loosen the front set screw with an Allen wrench. With the laser switched on, use needle nose pliers to rotate the front of the laser until the laser beam is in the same direction as the slot in the drill guide plate. When the laser beam and slot are parallel, hold position with pliers and retighten the set screw until it makes contact with the laser. Do not overtighten the set screw (figure 5).

**Figure 5**

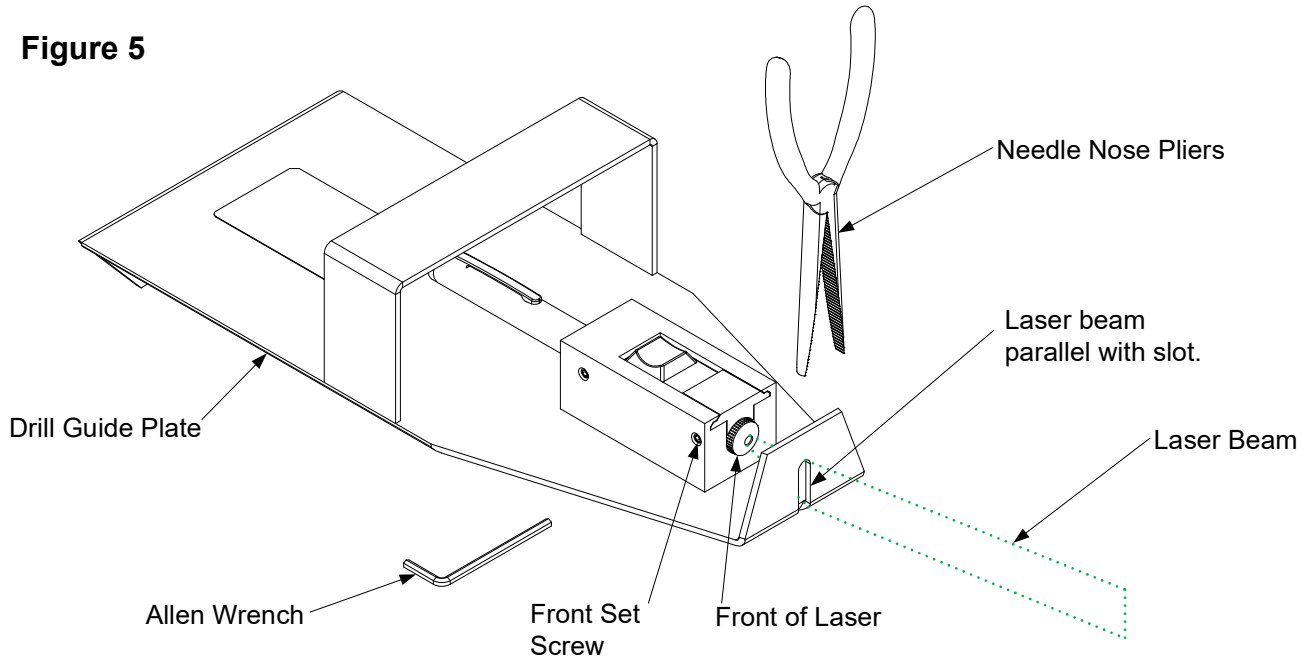

6. **Battery Replacement:** Unscrew the laser cap from the laser body and discard the old AAA batteries. Insert two new AAA batteries with positive (+) end first into the laser cap. Screw the laser cap back onto the laser body. If the laser cap does not thread on or off smoothly, loosen the rear set screw with an Allen wrench. Retighten the set screw once done. Do not overtighten the set screw (figure 6).

**Figure 6**

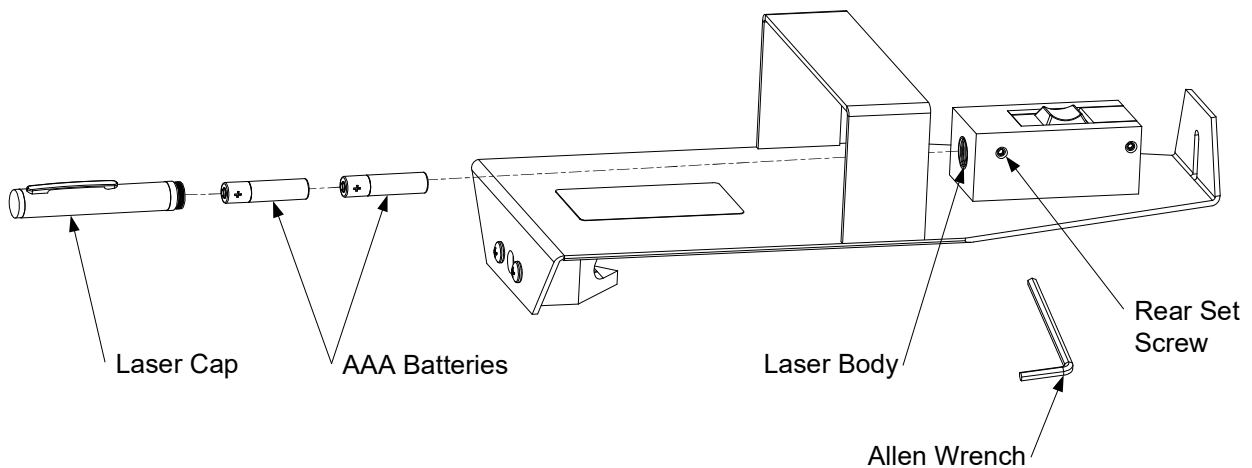

**SDC IS NOT RESPONSIBLE FOR MIS-DRILLED DOORS**