



INSTALLATION INSTRUCTIONS

LR100VDK-22V2 ELECTRIC LATCH RETRACTION DEVICE KIT VON DUPRIN MODELS: 22 & 2227

Retrofit Installation Note: 42" or 48" exit devices that have been modified to fit a 36" or smaller opening may not have the required space to fit the standard E. L. R. assembly. Always verify the distance from the end of the touchpad to the end rail and, if necessary, consult with the factory for appropriate selection.

ELECTRICAL DATA
24VDC +/- 10%
1.5A Inrush / 200mA holding
RED (+) BLK (-)
PATENT #8,851,530

Step 1

Remove device from door. Remove Von Duprin mechanical dogging assembly from Internal Assembly. Place provided Template in device Rail so that indicated edge is against the Internal Assembly Base Plate. Drill & tap for a 8-32 screw through Rail where indicated. Countersink the opposite side of hole.

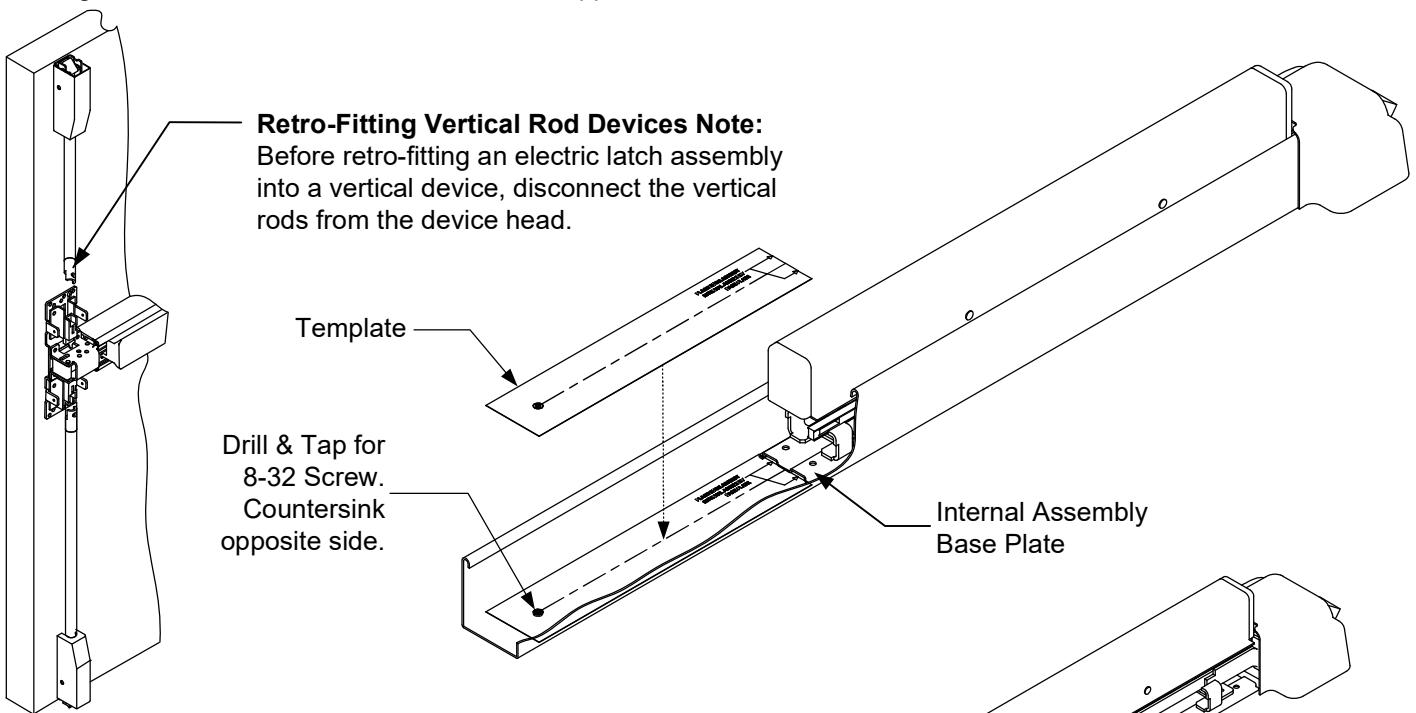

Step 2

Remove Rail Screws and slide the Internal Assembly out of the Rail.

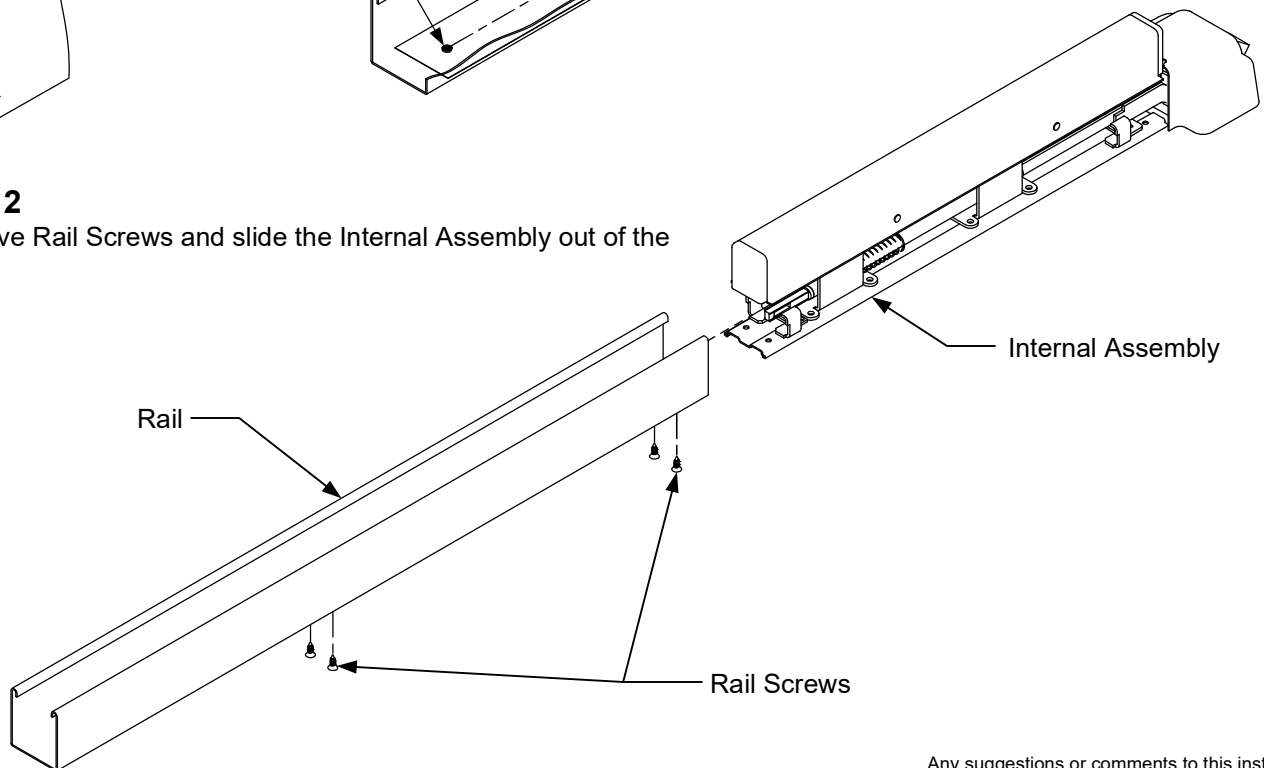

Any suggestions or comments to this instruction or product are welcome. Please contact us through our website or email engineer@sdsecurity.com

Step 3

Connect Linkage between Clevis and Latch Retraction Rod.
 Connect ELR Baseplate with Internal Assembly using
 Connecting Screws (8-32 x 3/8" Pan Head).

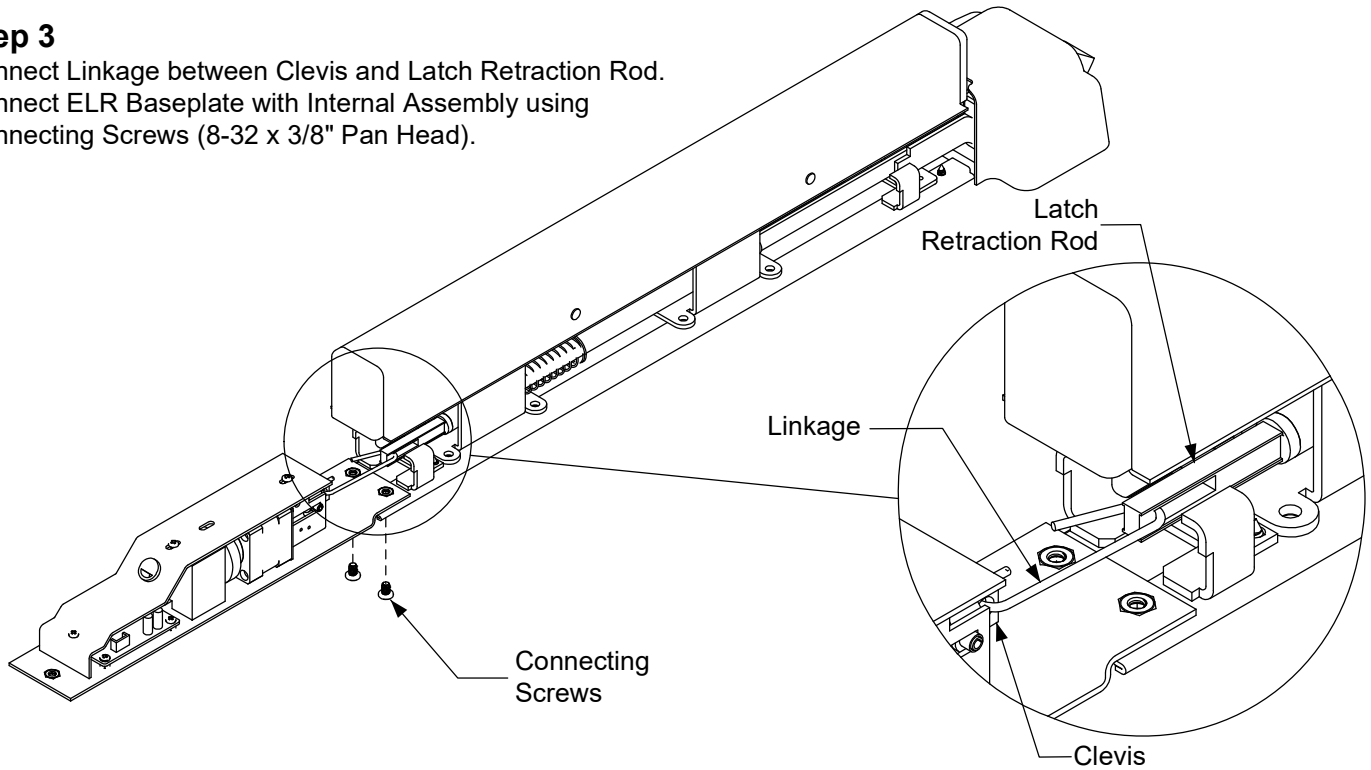

Step 4

Slide Internal Assembly with attached ELR back into Rail and re-fasten
 Rail Screws. Secure ELR with Fastening Screw (8-32 x 1/4" Flat Head).
 Re-mount device on door.

Note for Vertical Rod Devices: Once the ELR is properly installed,
 energize it so that the push pad is dogged down. This will allow for
 proper alignment of the vertical rods. Reconnect the vertical rods to
 the device and make the proper adjustments.

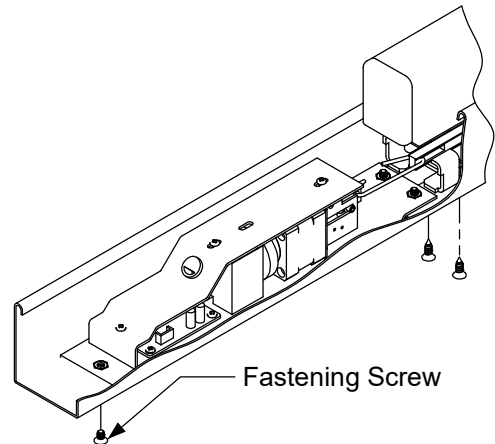

LR-1VD CONNECTING ROD INSTALL FOR USE ON VON DUPRIN DEVICES LESS DOGGING FEATURE

1. Remove the Push Pad from the device.
2. Drill a 5/32" (.156") diameter hole through top of Retraction Rod 1/4" (.25") from end as shown in illustration.
3. Insert the Connecting Rod provided and fasten with Connecting Rod Screw.

Note: When retrofitting to existing vertical rod devices, adjustment
 of the rods are required for proper assembly of the R100VDK-22V2
 Kit. Please see the SDC website (www.sdsecurity.com) for
 installation tips and photographs of installing.

