

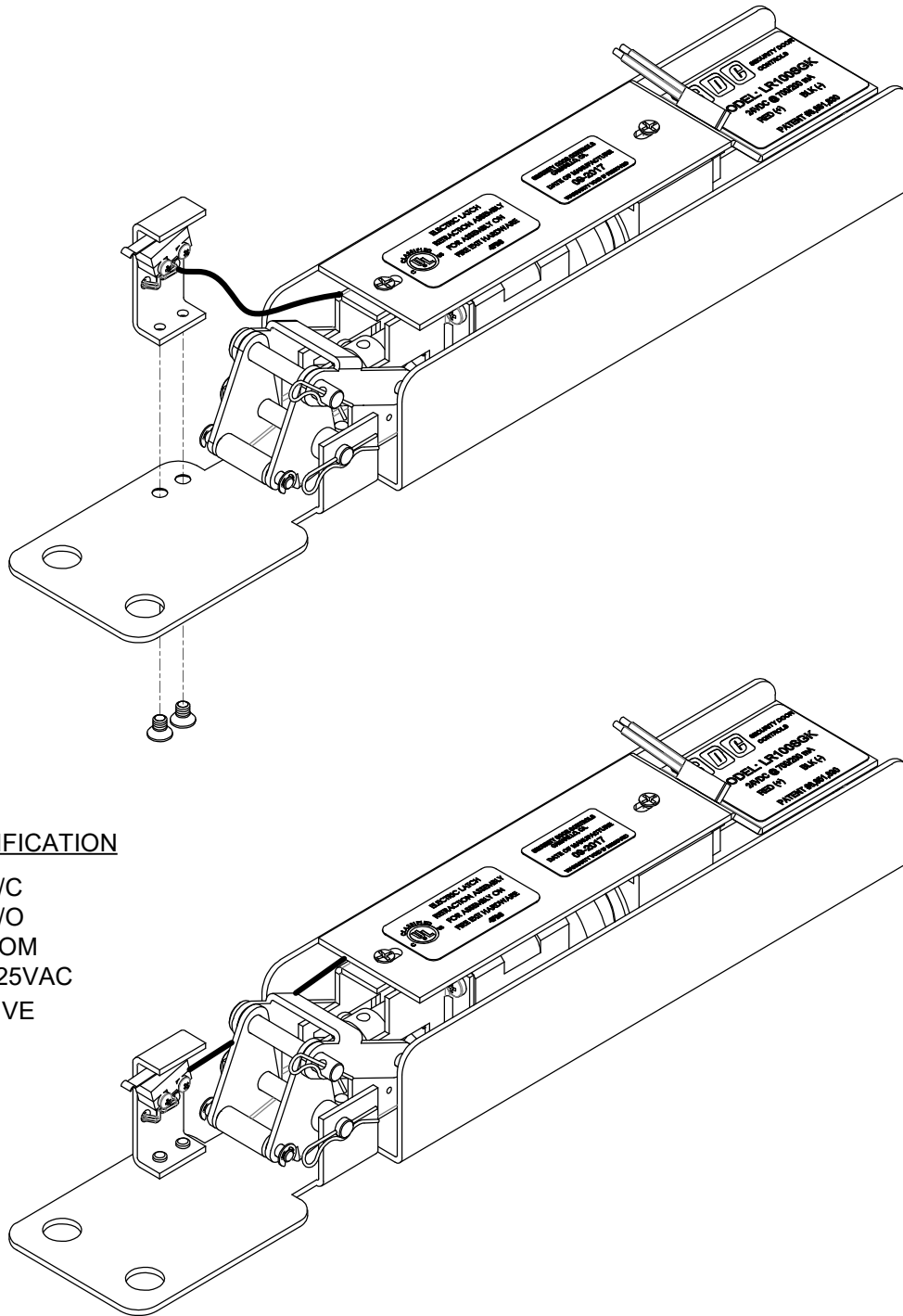

INSTALLATION INSTRUCTIONS

LRSG2R SARGENT REQUEST-TO-EXIT SWITCH KIT MODELS: LR100SGK & LR100SGK-EM

Attach the switch mounting bracket where shown. Run switch wires along the side of the housing.



SWITCH SPECIFICATION

ORG - N/C
YEL - N/O
WHT - COM
3 AMP @ 125VAC
RESISTIVE

Any suggestions or comments to this instruction or product are welcome. Please contact us through our website or email engineer@sdsecurity.com